

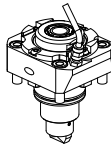

		PAGINA Page Seite
MODULO MOTORIZZATO RADIALE MAGGIORATO Radial driven tool Radial angetriebenes Werkzeug		EMG010.1.00
MODULO MOTORIZZATO RADIALE HSK Radial HSK driven tool Radial HSK angetriebenes Werkzeug		EMG010.1.00.H
MODULO MOTORIZZ. RADIALE HSK RIDOTTO l=2:1 DISASSATO IN Z 80mm Radial HSK geared-down l=2:1 driven tool re-directed in Z by 80mm Radial HSK angetriebenes Werkzeug untersetzt l=2:1 achsversetzt in Z um 80mm		EMG030.1.20.H
MODULO MOTORIZZATO ASSIALE H=85mm Axial driven tool H=85mm Axial angetriebenes Werkzeug H=85mm		EMG150.1.31
MODULO MOTORIZZATO ORIENTABILE ±90° H=54mm ±90° adjustable angle driven tool H=54mm Angetriebenes Werkzeug schwenkbar ±90° H=54mm		EMG333.1.00
MODULO MOTORIZZATO ORIENTABILE ±90° CON NONIO DIGITALE H=54mm ±90° adjustable angle driven tool with digital display H=54mm Angetriebenes Werkzeug schwenkbar ±90° mit digital display H=54mm		EMG333.1.01
PORTAUTENSILE RADIALE SINGOLO QD=20mm Radial single static tool QD=20mm Radial Single-Werkzeughalter QD=20mm		EMG420.1.00
PORTAUTENSILE ASSIALE SINGOLO QD=20mm Axial single static tool QD=20mm Axial Single-Werkzeughalter QD=20mm		EMG550.1.00
PORTAUTENSILE RADIALE PER BARENO Ø40mm Radial single boring bar holder Ø40mm Radial Bohrhalter Ø40mm		EMG575.1.00

PORTAUTENSILE RADIALE SINGOLO MT CAPTO Radial single static tool MT CAPTO Radial Single-Werkzeughalter MT CAPTO		EMG575.A.50
--	---	-------------

Distributeur/ importateur : Crylax 0033 450 960920 - info@crylax.com

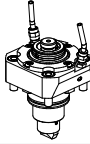
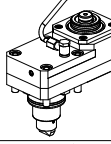
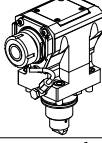

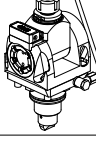
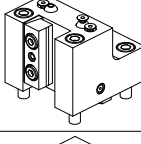
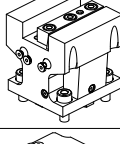
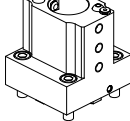
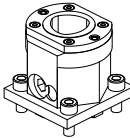
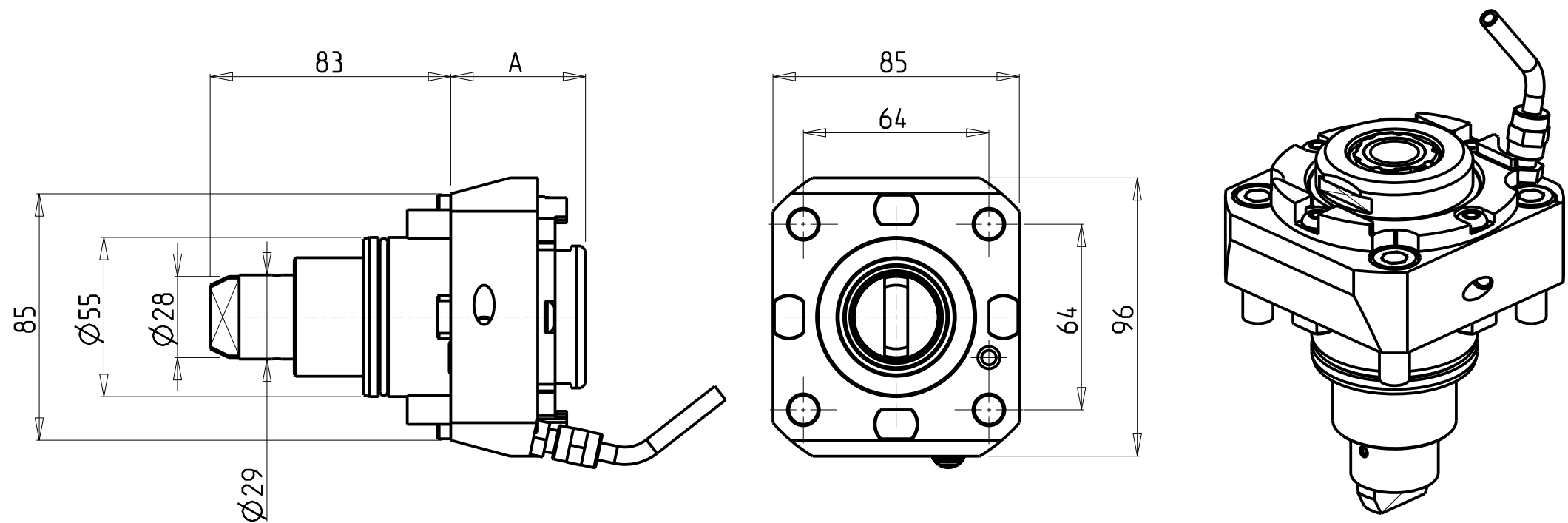
Cod. MT	Mandrino Spindle Spindel	I	RPM	Coppia Max Max Torque Max Drehmoment	Lubrificazione int. Coolant through Innenkuehlung	Lubrificazione est. Ext. coolant Aussenkuehlung	A	CHIAVI NON INCLUSE Keys not included Schlüssel nicht einbegriffen		
DW 02010325	ERA25	1:1	6000	50Nm	-	X	46.5	CHUB27	CHTAER25ZC	OKU0650004
DW 02010425	ERA25	1:1	6000	50Nm	P=30bar	X	59.5	CHUB27	CHTAER25ZC	OKU0650004
DW 02010132	ER32	1:1	6000	50Nm	-	X	71.2	-	CHSTER32	OKU0650004

- Chiave inclusa
- Key included
- Schlüssel inbegriffen

EMAG
MOD: VL2 - VL2 P - VL4-V2 - VLC100 - VT2 - VTC100-4 (BMT55 SHORT)
MODULO MOTORIZZATO RADIALE
Radial driven tool
Radial angetriebenes Werkzeug
Subject to change without notice.

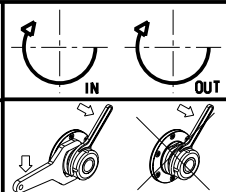

M.T. srl
Via Casino Albini 480
Tel. 0541/956034-957884
Fax 0541/956341
47842 S. GIOVANNI IN M. (RN)
e-mail: mtma@mtmarchetti.com
<http://www.mtmarchetti.com>

PRODUZIONE MODULI ROTANTI



PAGINA EMG010-1-00

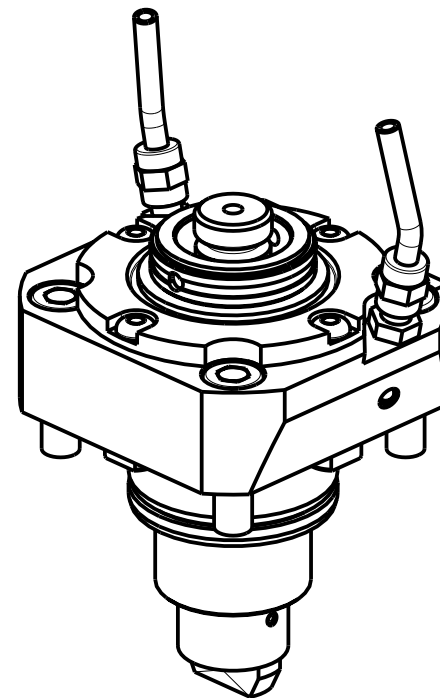
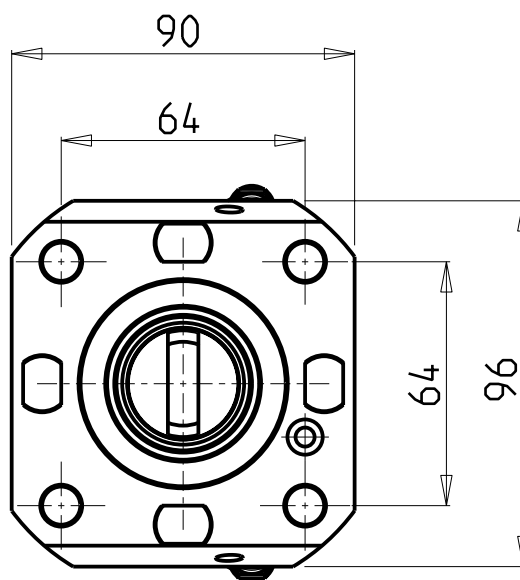
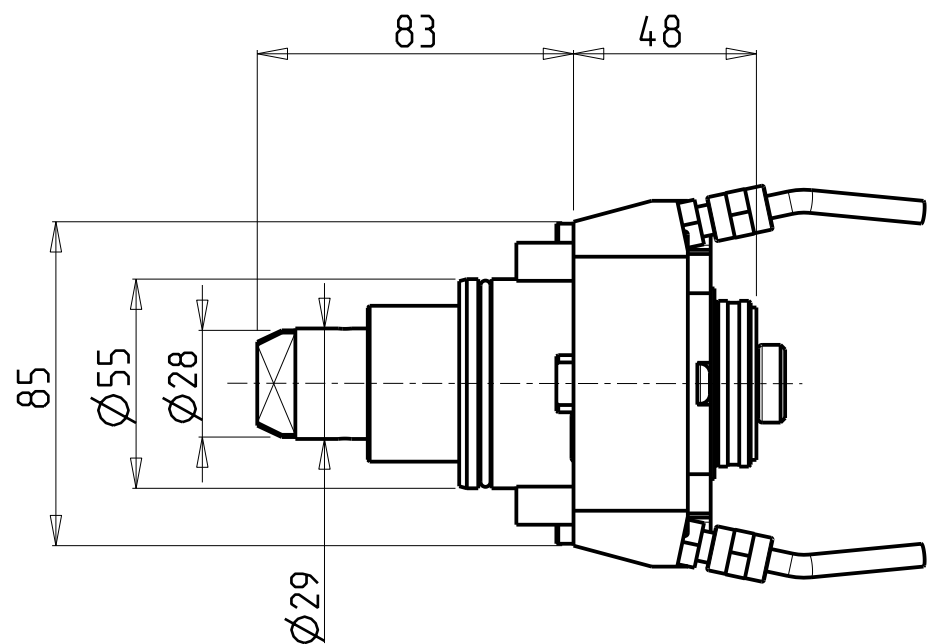

Cod. MT	Mandrino Spindle Spindel	I	RPM	Coppia Max Max Torque Max Drehmoment	Lubrificazione est. Ext. coolant Aussenkuehlung
DW 01660140	HSK-40	1:1	6000	50Nm	X

EMAG
MOD: VL2 - VL2 P - VL4-V2 - VLC100 - VT2 - VTC100-4 (BMT55 SHORT)
MODULO MOTORIZZATO RADIALE HSK
Radial HSK driven tool
Radial HSK angetriebenes Werkzeug

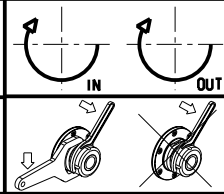

M.T. srl
Via Casino Albini 480
Tel. 0541/956034-957884
Fax 0541/956341
47842 S. GIOVANNI IN M. (RN)
e-mail: mtma@mtmarchetti.com
<http://www.mtmarchetti.com>

PRODUZIONE MODULI ROTANTI



PAGINA EMG010-1-00-H

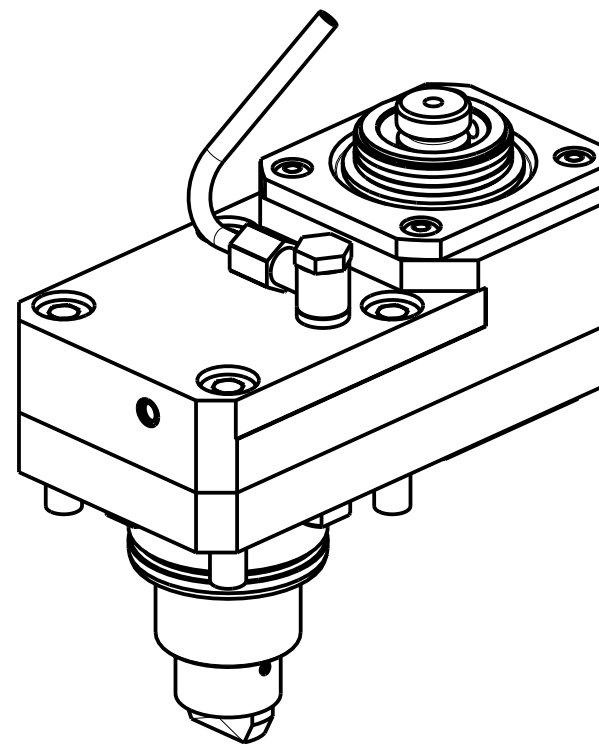
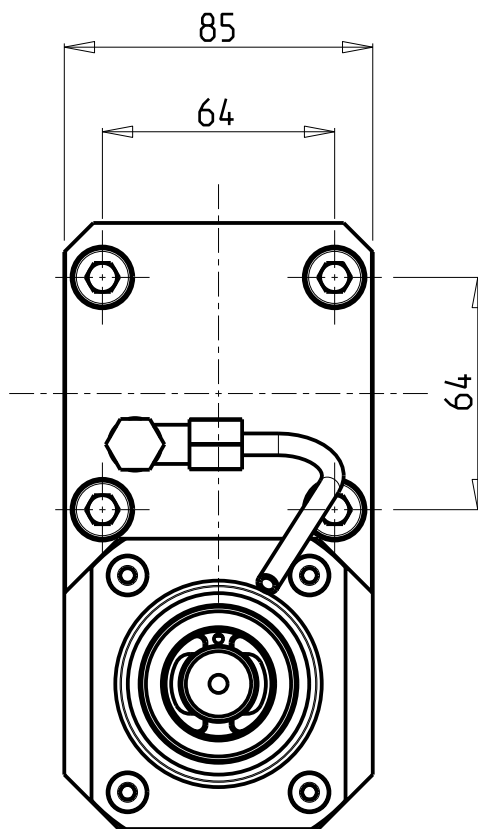
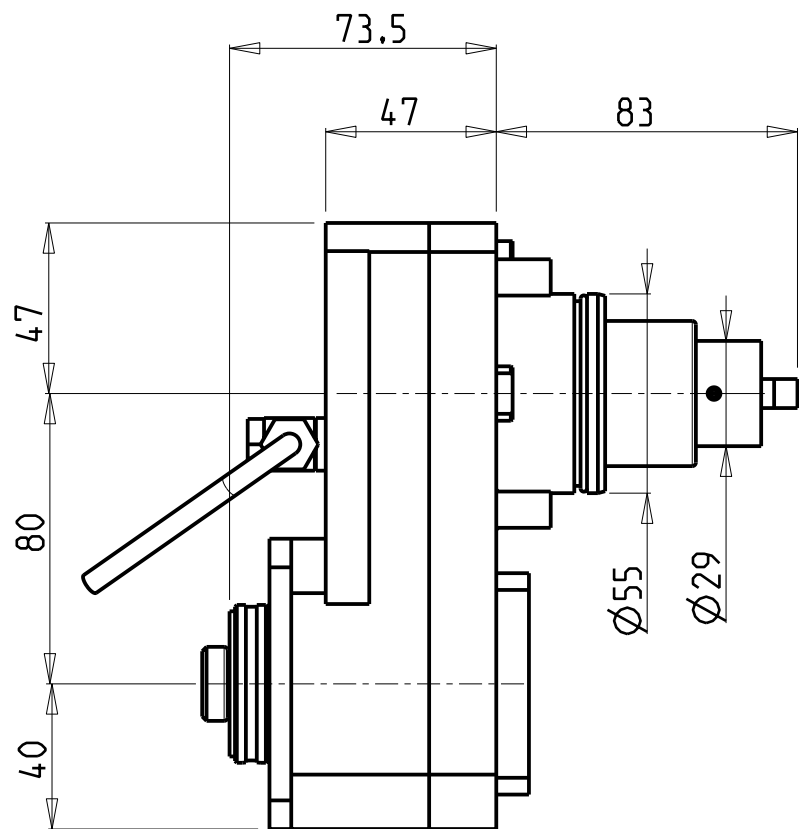

Cod. MT	Mandrino Spindle Spindel	I	RPM	Coppia Max Max Torque Max Drehmoment	Reversibile lato mandrino/contromandrino Reversible sub/main spindle side Umkehrbare Spindel-seite/ Gegenspindel-seite	Lubrificazione est. Ext. coolant Aussenkuehlung
DW01740140	HSK-40	2:1	3000	90Nm	X	X

EMAG
MOD: VL2 - VL2 P - VL4-V2 - VLC100 - VT2 - VTC100-4 (BMT55 SHORT)
MODULO MOTORIZZATO RADIALE HSK RIDOTTO I=2:1 DISASSATO IN Z 80mm
Radial HSK geared-down I=2:1 driven tool re-directed in Z by 80mm
Radial HSK angetriebenes Werkzeug untersezt I=2:1 achsversetzt in Z um 80mm

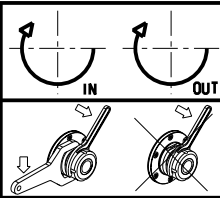



M.T. srl
Via Casino Albini 480
Tel. 0541/956034-957884
Fax 0541/956341
47842 S. GIOVANNI IN M. (RN)
e-mail: mtma@mtmarchetti.com
<http://www.mtmarchetti.com>

PRODUZIONE MODULI ROTANTI



PAGINA EMG030-1-20-H

<p>EMAG</p> <p>MOD: VL2 - VL2 P - VL4-V2 - VLC100 - VT2 - VTC100-4 (BMT55 SHORT)</p>		<p>M.T. srl</p> <p>Via Casino Albini 480</p> <p>Tel. 0541/956034-957884</p> <p>Fax 0541/956341</p>	<p>PRODUZIONE MODULI ROTANTI</p> 
<p>MODULO MOTORIZZATO ASSIALE H=85mm</p> <p>Axial driven tool H=85mm</p> <p>Axial angetriebenes Werkzeug H=85mm</p>		<p>47842 S. GIOVANNI IN M. (RN)</p> <p>e-mail: mtma@mtmarchetti.com</p> <p>http://www.mtmarchetti.com</p>	<p>PAGINA EMG150-1-31</p>

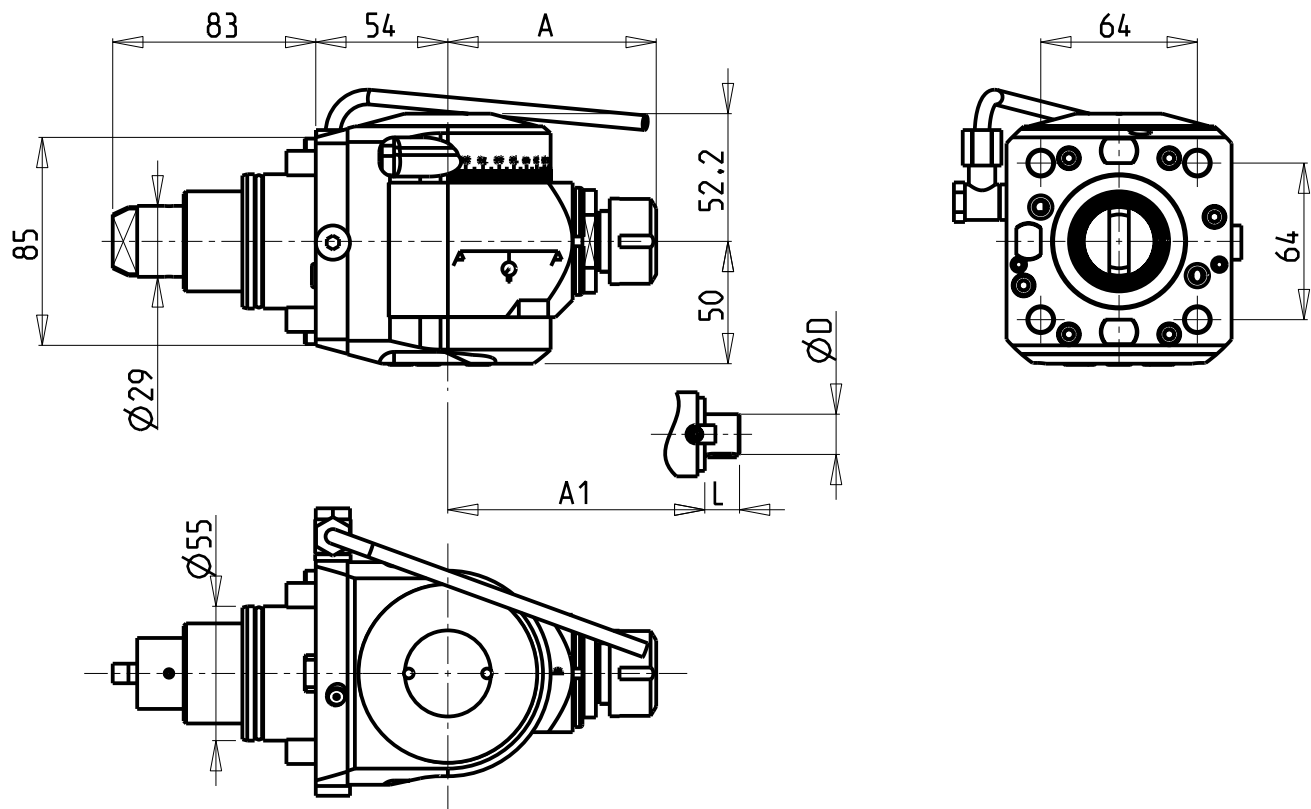

ATTENZIONE - ATTENTION - ACHTUNG

- VERIFICARE LE MISURE DI INGOMBRO PER POSSIBILE INTERFERENZA SU ALCUNI MODELLI DI MACCHINE
- Please check the overall sizes for possible interferences on some machine models
- Bitte überprüfen sie das ausmass um mögliche interferenzen auf einigen maschinen modellen zu vermeiden

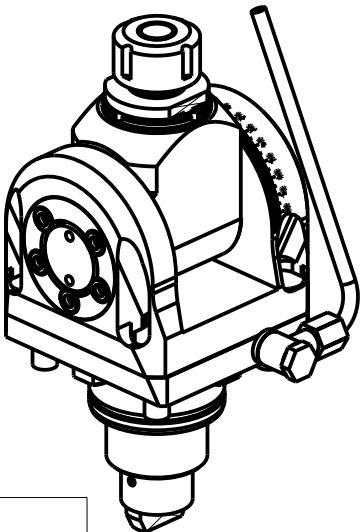

Cod. MT	Mandrino Spindle Spindel	I	RPM	Coppia Max Max Torque Max Drehmoment	Reversibile lato mandrino/contromandrino Reversible sub/main spindle side Umkehrbare Spindel-seite/ Gegenspindel-seite	Lubrificazione est. Ext. coolant Aussenkuehlung	A	A1	D	L	CHIAVI INCLUSE Keys included Schluessel inbegriffen		
DW 02100120	ER20	1:1	6000	40Nm	X	X	85.16	-	-	-	CHSTER20	CHUB36	CHESL08
DW 02100125	ER25	1:1	6000	40Nm	X	X	86.16	-	-	-	CHSTER25	CHUB36	CHESL08
DW 02100516	Ø16x17	1:1	6000	40Nm	X	X	-	65	16	17	CH_VTCROCE_M08	CHUB36	CHESL08
DW 02100522	Ø22x19	1:1	6000	40Nm	X	X	-	66	22	19	CH_VTCROCE_M10	CHUB36	CHESL08
DW 02100519	Ø3/4"x3/4"	1:1	6000	40Nm	X	X	-	65	3/4"	3/4"	CH_VTCROCE_M08	CHUB36	CHESL08

EMAG
MOD: VL2 - VL2 P - VL4-V2 - VLC100 - VT2 - VTC100-4 (BMT55 SHORT)
MODULO MOTORIZZATO ORIENTABILE ±90° H=54mm
±90° adjustable angle driven tool H=54mm
Angetriebenes Werkzeug schwenkbar ±90° H=54mm
Subject to change without notice.

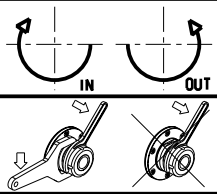

M.T. srl
Via Casino Albini 480
Tel. 0541/956034-957884
Fax 0541/956341
47842 S. GIOVANNI IN M. (RN)
e-mail: mtma@mtmarchetti.com
<http://www.mtmarchetti.com>

PRODUZIONE MODULI ROTANTI

PAGINA EMG333-1-00

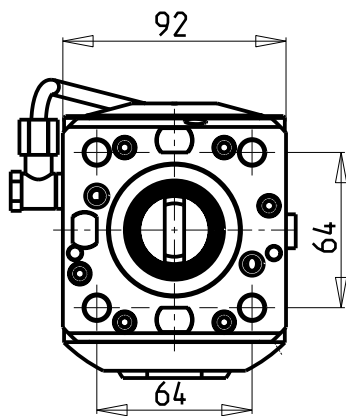
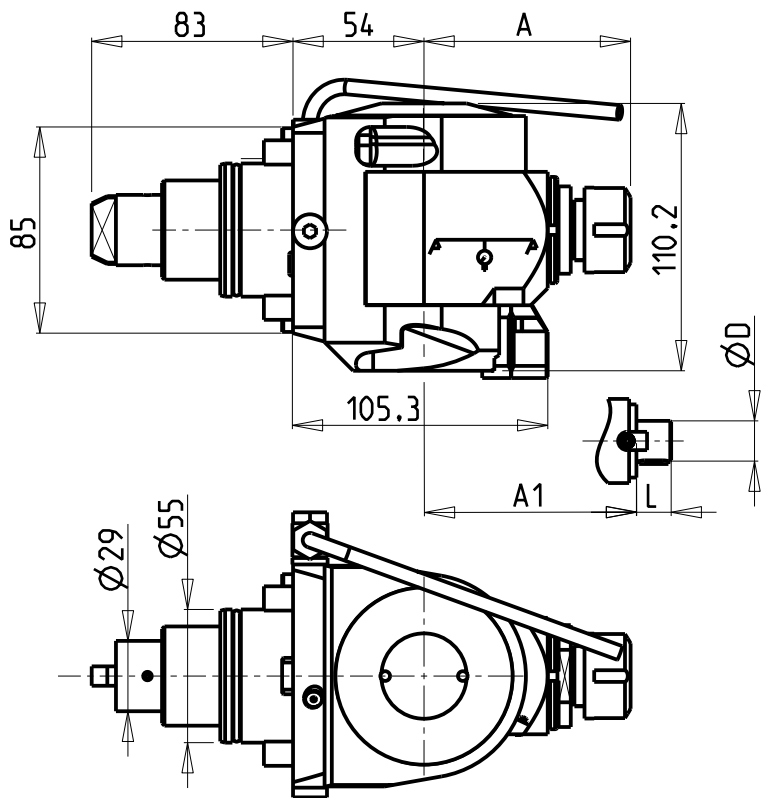

ATTENZIONE - ATTENTION - ACHTUNG

- VERIFICARE LE MISURE DI INGOMBRO PER POSSIBILE INTERFERENZA SU ALCUNI MODELLI DI MACCHINE
- Please check the overall sizes for possible interferences on some machine models
- Bitte überprüfen sie das ausmass um mögliche interferenzen auf einigen maschinen modellen zu vermeiden

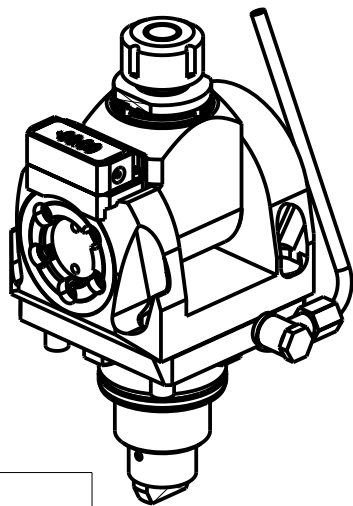

Cod. MT	Mandrino Spindle Spindel	I	RPM	Coppia Max Max Torque Max Drehmoment	Reversibile lato mandrino/contromandrino Reversible sub/main spindle side Umkehrbare Spindelseite/ Gegenspindelseite	Lubrificazione est. Ext. coolant Aussenkuehlung	A	A1	D	L	CHIAVI INCLUSE Keys included Schluessel inbegriffen		
DW 02110120	ER20	1:1	6000	40Nm	X	X	85.16	-	-	-	CHSTER20	CHUB36	CHESL08
DW 02110125	ER25	1:1	6000	40Nm	X	X	86.16	-	-	-	CHSTER25	CHUB36	CHESL08
DW 02110516	Ø16x17	1:1	6000	40Nm	X	X	-	65	16	17	CH_VTCROCE_M08	CHUB36	CHESL08
DW 02110522	Ø22x19	1:1	6000	40Nm	X	X	-	66	22	19	CH_VTCROCE_M10	CHUB36	CHESL08
DW 02110519	Ø3/4"x3/4"	1:1	6000	40Nm	X	X	-	65	3/4"	3/4"	CH_VTCROCE_M08	CHUB36	CHESL08

EMAG
MOD: VL2 - VL2 P - VL4-V2 - VLC100 - VT2 - VTC100-4 (BMT55 SHORT)
MODULO MOTORIZZATO ORIENTABILE ±90° CON NONIO DIGITALE H=54mm
±90° adjustable angle driven tool with digital display H=54mm
Angetriebenes Werkzeug schwenkbar ±90° mit digital display H=54mm

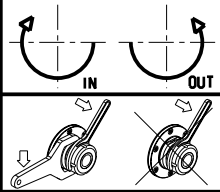

M.T. srl
Via Casino Albini 480
Tel. 0541/956034-957884
Fax 0541/956341
47842 S. GIOVANNI IN M. (RN)
e-mail: mtma@mtmarchetti.com
<http://www.mtmarchetti.com>

PRODUZIONE MODULI ROTANTI

PAGINA EMG333-1-01

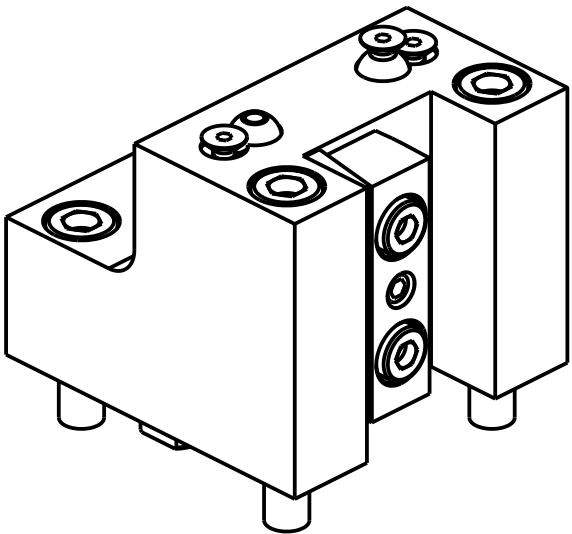
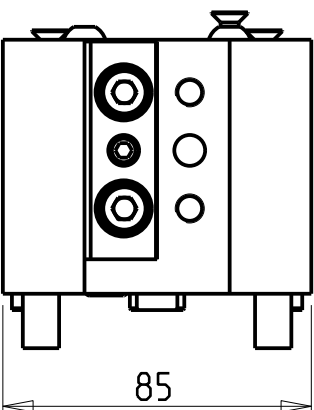
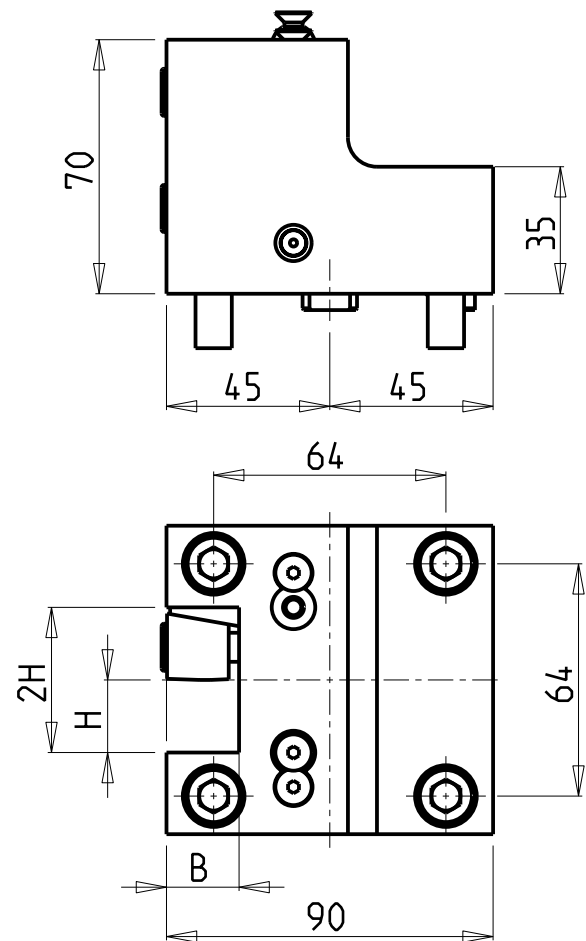

Cod. MT	N°Utensili N°Tools N°Werkzeuge	Misure Dimensions Masse	B	H
DW02082000	1	mm	20	20

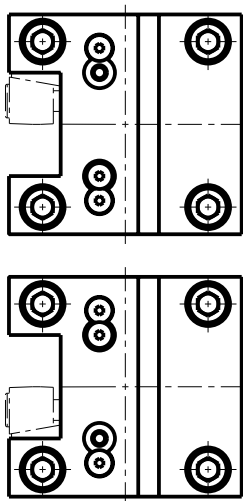

EMAG
MOD: VL2 - VL2 P - VL4-V2 - VLC100 - VT2 - VTC100-4
PORTAUTENSILE RADIALE SINGOLO QD=20mm
Radial single static tool QD=20mm
Radial Single-Werkzeughalter QD=20mm

Subject to change without notice.

M.T. srl
Via Casino Albini 480
Tel. 0541/956034-957884
Fax 0541/956341
47842 S. GIOVANNI IN M. (RN)
e-mail: mtma@mtmarchetti.com
<http://www.mtmarchetti.com>

PRODUZIONE MODULI ROTANTI

PAGINA EMG420-1-00

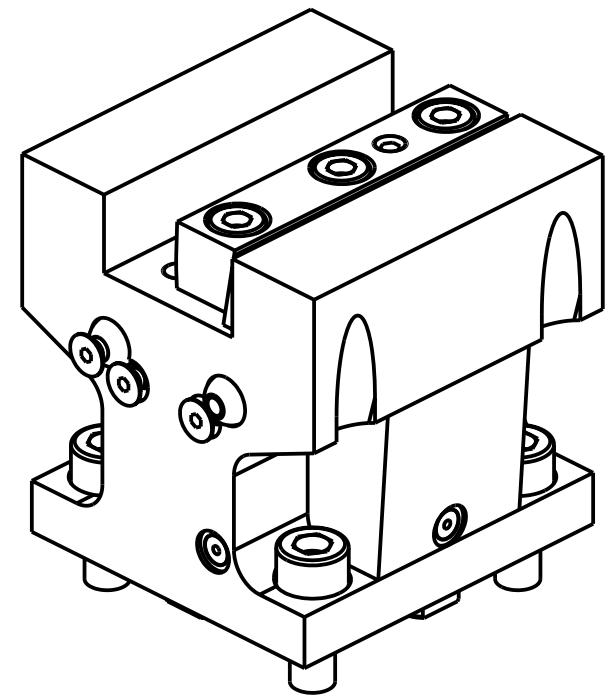
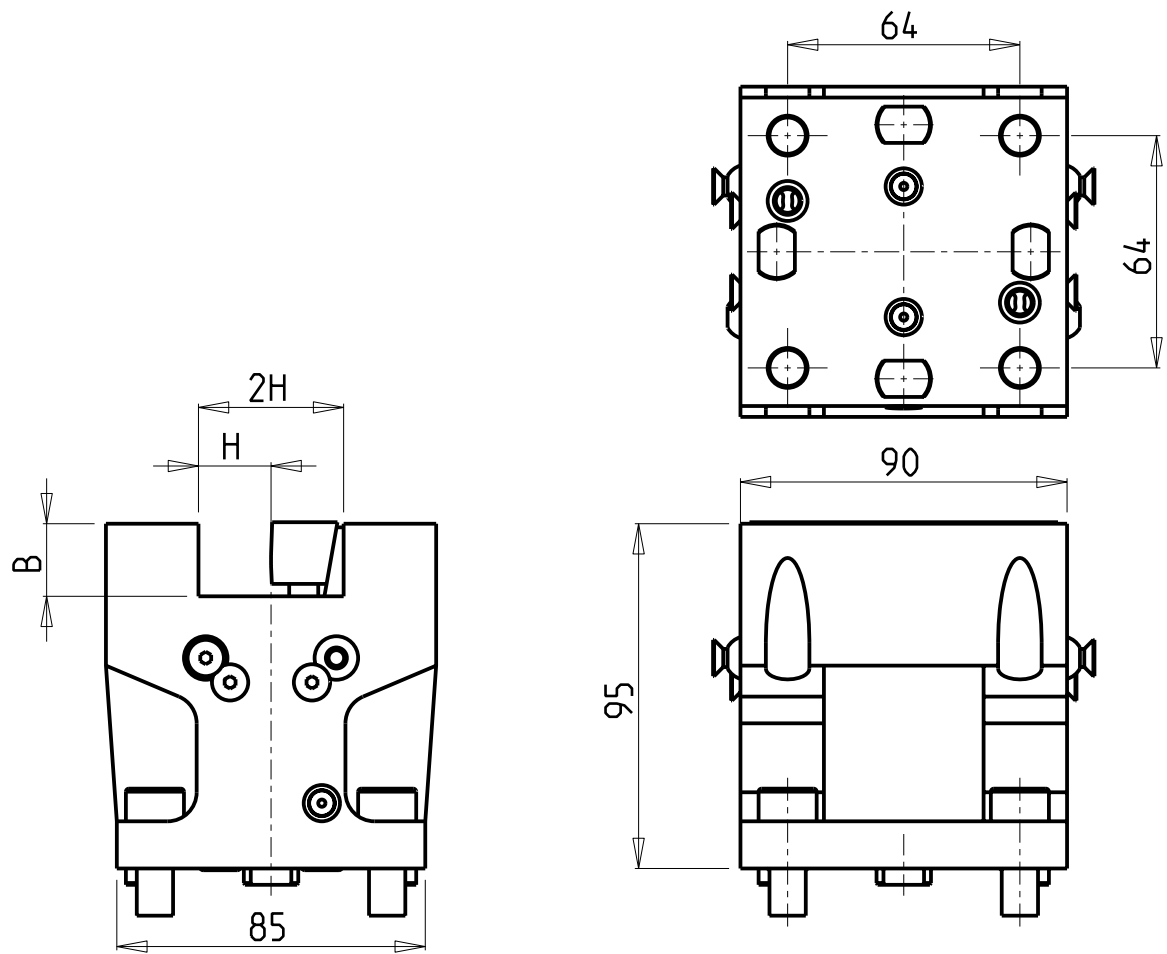

Cod. MT	N°Utensili N°Tools N°Werkzeuge	Reversibile lato mandrino/controlmandrino Reversible sub/main spindle side Umkehrbare Spindel-seite/ Gegenspindel-seite	Misure Dimensions Masse	B	H
DW 02072000	1	X	mm	20	20

EMAG		M.T. srl Via Casino Albini 480 Tel. 0541/956034-957884 Fax 0541/956341 47842 S. GIOVANNI IN M. (RN) e-mail: mtma@mtmarchetti.com http://www.mtmarchetti.com	 PRODUZIONE MODULI ROTANTI
MOD: VL2 - VL2 P - VL4-V2 - VLC100 - VT2 - VTC100-4			
PORTAUTENSILE ASSIALE SINGOLO QD=20mm Axial single static tool QD=20mm Axial Single-Werkzeughalter QD=20mm			
PAGINA EMG550-1-00			

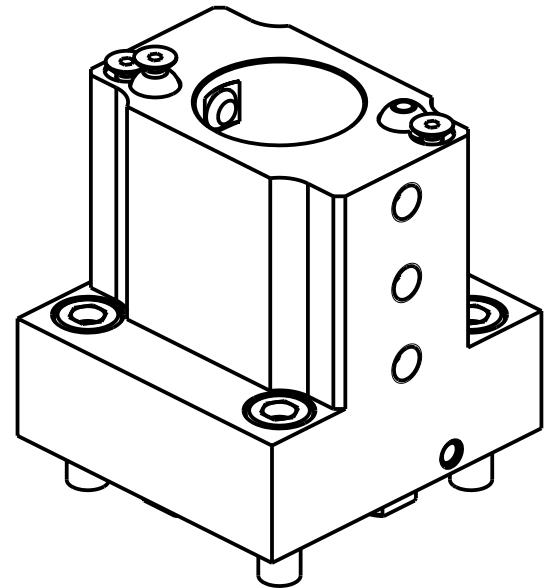
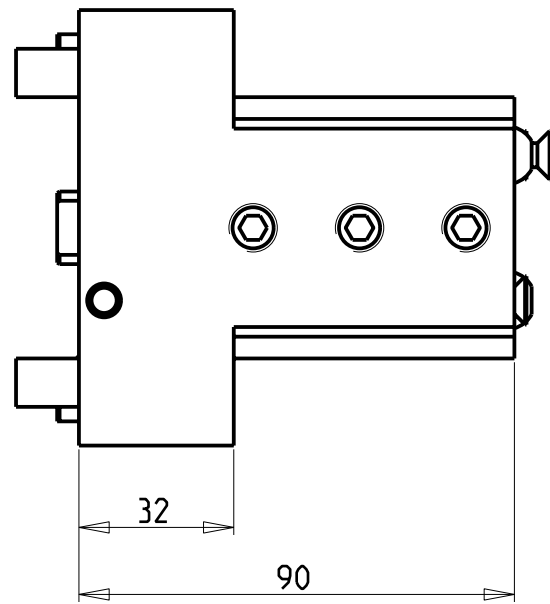
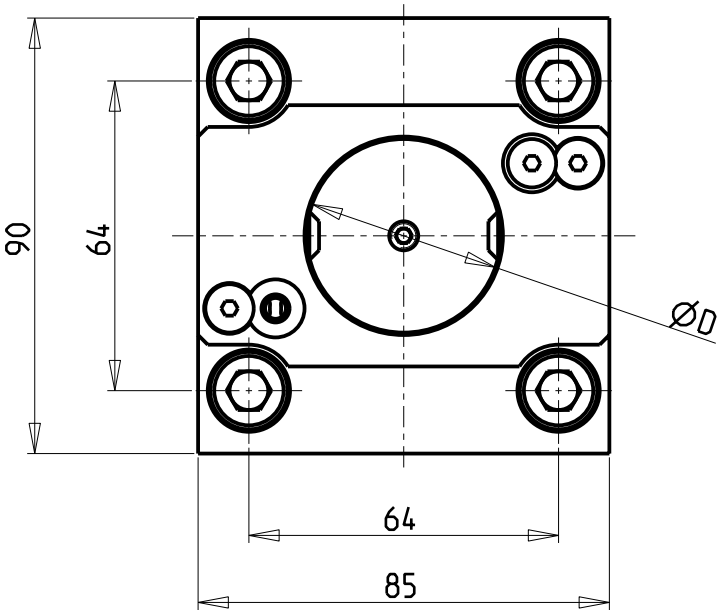

Cod. MT	N°Utensili N°Tools N°Werkzeuge	Lubrificazione est. Ext. coolant Aussenkuehlung	Lubrificazione int. Coolant through Innenkuehlung	Misure Dimensions Masse	D
DW02064000	1	X	X	mm	40

PER BOCCOLE DI RIDUZIONE VEDI PAG. TBL150-1-00
FOR REDUCING BUSHINGS SEE PAGE TBL150-1-00
FÜR REDUZIERBUCHSE SIEHE SEITE TBL150-1-00

EMAG
MOD: VL2 - VL4-V2 - VLC100
PORTAUTENSILE RADIALE PER BARENO Ø40mm
Radial single boring bar holder Ø40mm
Radial Bohrhälter Ø40mm

Subject to change without notice.

M.T. srl
Via Casino Albini 480
Tel. 0541/956034-957884
Fax 0541/956341
47842 S. GIOVANNI IN M. (RN)
e-mail: mtma@mtmarchetti.com
<http://www.mtmarchetti.com>

PRODUZIONE MODULI ROTANTI

**MT**

PAGINA EMG575-1-00

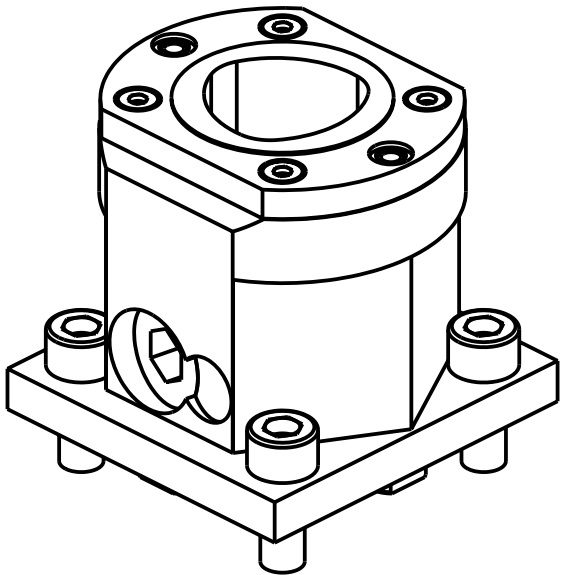
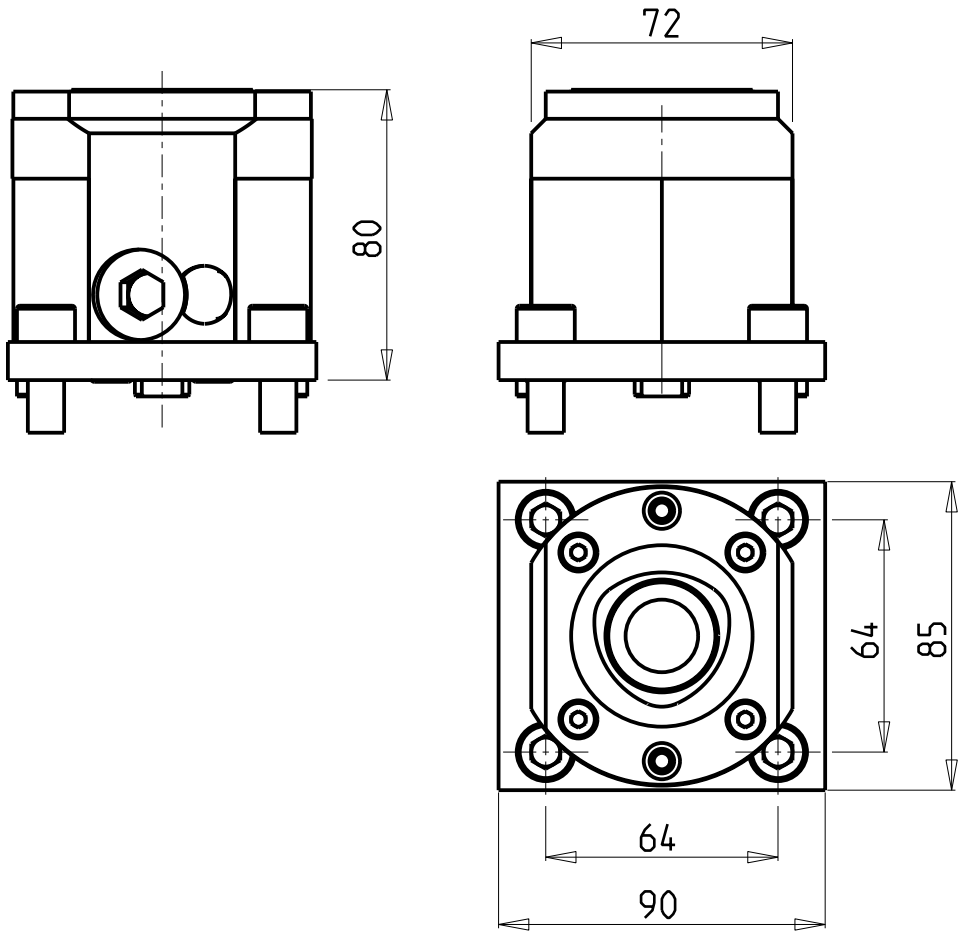

Cod. MT	N°Utensili N°Tools N°Werkzeuge	Lubrificazione int. Coolant through Innenkuehlung	TAGLIA Size Masse
DW02675010	1	X	C5

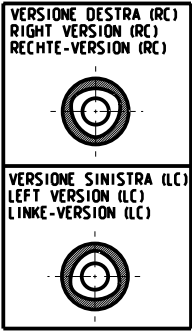

PER ORDINARE LA VERSIONE SX
AGGIUNGERE "LC" AL CODICE IN TABELLA.
ES: DW02675010 DIVENTA DW02675010LC

TO ORDER LEFT VERSION
ADD A "LC" IN THE CODE-CHARTS.
EXAMPLE: DW02675010 BECOMES DW02675010LC

UM DIE LINKE-VERSION ZU BESTELLEN, BEI DER
ARTIKELBEZEICHNUNG "LC" HINZUFUEGEN.
BEISPIEL: DW02675010 WIRD DANN DW02675010LC

EMAG
MOD: VL2 - VL4-V2 - VLC100
PORTAUTENSILE RADIALE SINGOLO MT CAPTO
Radial single static tool MT CAPTO
Radial Single-Werkzeughalter MT CAPTO

Subject to change without notice.

M.T. srl
Via Casino Albini 480
Tel. 0541/956034-957884
Fax 0541/956341
47842 S. GIOVANNI IN M. (RN)
e-mail: mtma@mtmarchetti.com
<http://www.mtmarchetti.com>

PRODUZIONE MODULI ROTANTI



PAGINA EMG575-A-50