

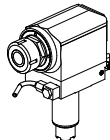



		PAGINA Page Seite
MODULO MOTORIZZATO RADIALE VD140 H=75 mm Radial driven tool VD140 H=75mm Radial angetriebenes Werkzeug VD140 H=75mm		OKU013.3.10
MODULO MOTORIZZATO RADIALE MTSK VD140 H=75mm Radial MTSK driven tool VD140 H=75mm Radial MTSK angetriebenes Werkzeug VD140 H=75mm		OKU013.3.10.K
MODULO MOTORIZZATO RADIALE VD140 H=90mm Radial driven tool VD140 H=90mm Radial angetriebenes Werkzeug VD140 H=90mm		OKU013.3.20
MODULO MOTORIZZATO RADIALE MTSK VD140 H=90mm Radial MTSK driven tool VD140 H=90mm Radial MTSK angetriebenes Werkzeug VD140 H=90mm		OKU013.3.20.K
MODULO MOTORIZZATO RADIALE ARRETRATO VD140 Radial rear-set driven tool VD140 Radial angetriebenes Werkzeug zurueckversetzt VD140		OKU015.3.00
MODULO MOTORIZZATO RADIALE MOLTIPLICATO I=1:3 VD140 H=75mm Radial geared-up I=1:3 driven tool VD140 H=75mm Radial angetriebenes Werkzeug uebersetzt I=1:3 VD140 H=75mm		OKU018.3.14
MODULO MOTORIZZATO RADIALE MOLTIPLICATO I=1:3 VD140 H=90mm Radial geared-up I=1:3 driven tool VD140 H=90mm Radial angetriebenes Werkzeug uebersetzt I=1:3 VD140 H=90mm		OKU018.3.24
MODULO MOTORIZZATO RADIALE VD140 H=150mm Radial driven tool VD140 H=150mm Radial angetriebenes Werkzeug VD140 H=150mm		OKU125.3.00
MODULO MOTORIZZ. ASSIALE DISASSATO 30mm ORIENTABILE $\pm 30^\circ$ VD140 Axial $\pm 30^\circ$ adjustable angle driven tool re-directed by 30mm VD140 Axial angetriebenes Werkzeug schwenkbar $\pm 30^\circ$ achsversetzt um 30mm VD140		OKU135.3.00
MODULO MOTORIZZATO ASSIALE VD140 Axial driven tool VD140 Axial angetriebenes Werkzeug VD140		OKU150.3.00
MODULO MOTORIZZATO ASSIALE DISASSATO VD140 Axial re-directed driven tool VD140 Axial angetriebenes Werkzeug achsversetzt VD140		OKU160.3.00
MODULO MOTORIZZATO ASSIALE RIDOTTO I=2:1 DISASSATO VD140 Axial geared-down I=2:1 driven tool re-directed VD140 Axial angetriebenes Werkzeug untersetzt I=2:1 achsversetzt VD140		OKU160.3.10

		PAGINA Page Seite
MODULO MOTORIZZ. ASSIALE MOLTIPLICATO 1=1:2 DISASSATO 42mm VD140 Axial geared-up 1=1:2 driven tool re-directed by 42mm VD140 Axial angetriebenes Werkzeug uebersetzt 1=1:2 achsversetzt um 42mm VD140		OKU160.3.20
MODULO MOTORIZZATO ORIENTABILE ±90° VD140 ±90° adjustable angle driven tool VD140 Angetriebenes Werkzeug schwenkbar ±90° VD140		OKU333.3.00
MODULO MOTORIZZATO ORIENTABILE ±90° CON NONIO DIGITALE VD140 ±90° adjustable angle driven tool with digital display VD140 Angetriebenes Werkzeug schwenkbar ±90° mit digital display VD140		OKU333.3.01
MODULO MOTORIZZATO PORTACREATORE VD140 Driven gear hobber VD140 Angetriebenes Zahnradwaelzfraes-Werkzeug VD140		OKU340.3.00

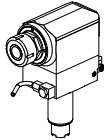
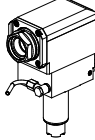
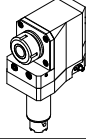
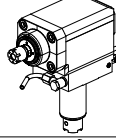
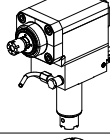
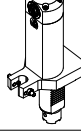
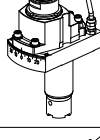
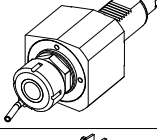
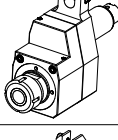
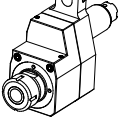
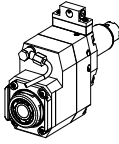

ATTENZIONE - ATTENTION - ACHTUNG

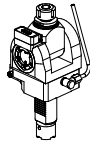
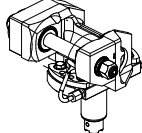
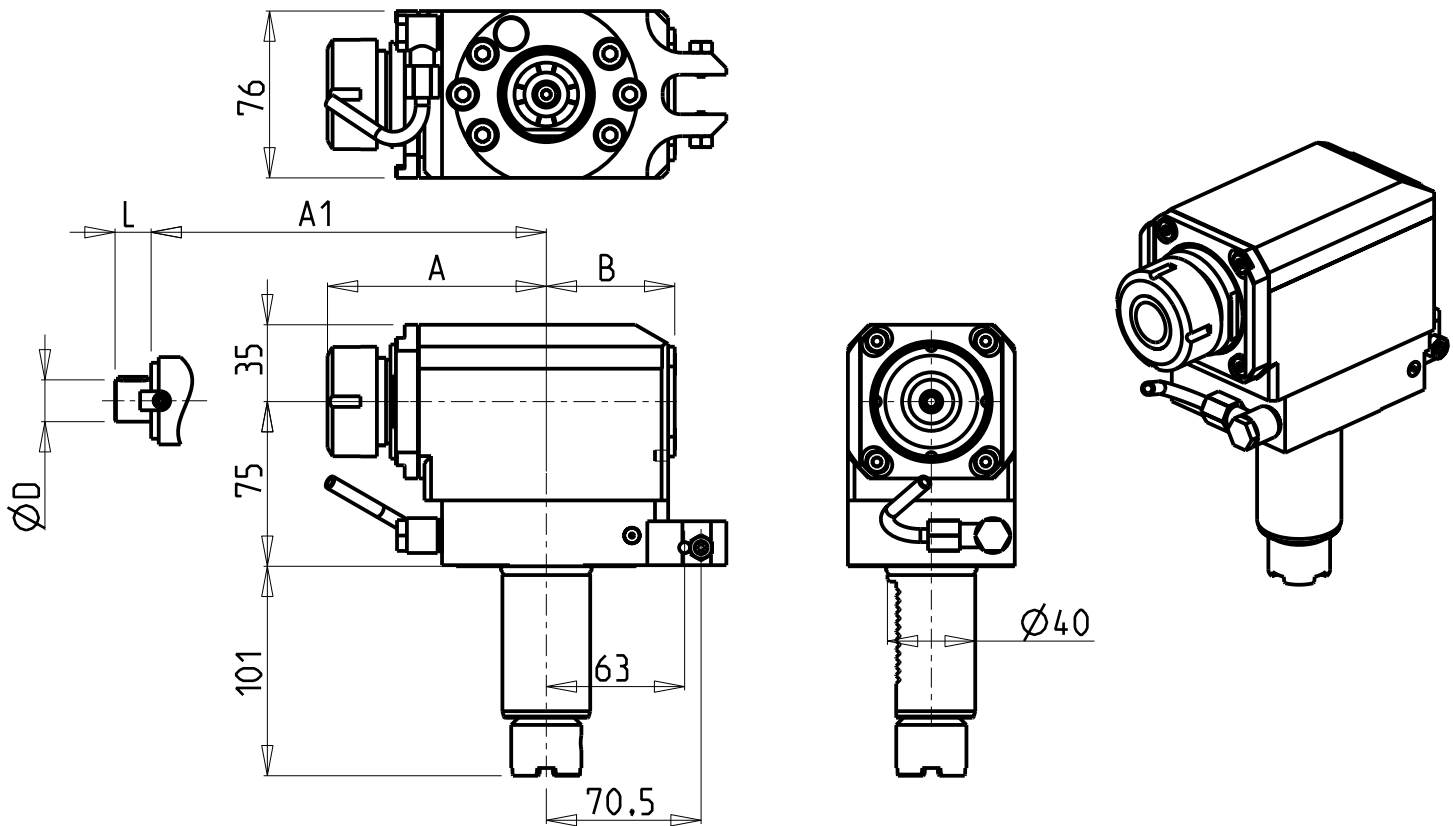
- Per lo smontaggio degli utensili utilizzare sempre la chiave di contrasto come indicato nel manuale d'uso.
- For disassembly of the tools use always the contrast key as mentioned in the user instructions.
- Fuer das Abmontieren der Werkzeuge immer den Gegenschlüssel benutzen wie in der Bedienungsanleitung erwaeht.

**TORRETTE ASSIALI
AXIAL TURRETS
AXIAL REVOLVER**

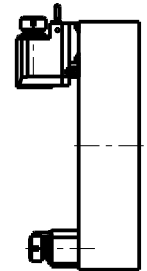

- Chiave inclusa
- Key included
- Schluessel inbegriffen

Cod. MT	Mandrino Spindle Spindel	I	RPM	Coppia Max Max Torque Max Drehmoment	Lubrificazione int. Coolant through Innenkuhlung	Lubrificazione est. Ext. coolant Aussenkuhlung	A	A1	B	D	L	CHIAVI NON INCLUDE Keys not included Schluessel nicht einbegriffen	
OKU0040332	ER32	1:1	4000	70Nm	-	X	99.7	-	58.5	-	-	OKU0650004	CHSTER32
OKU0040432	ER32	1:1	4000	70Nm	P=70bar	X	99.7	-	69.5	-	-	OKU0650004	CHSTER32
OKU0040340	ER40	1:1	4000	70Nm	-	X	103.7	-	58.5	-	-	OKU0650004	CHSTER40
OKU0040440	ER40	1:1	4000	70Nm	P=70bar	X	103.7	-	69.5	-	-	OKU0650004	CHSTER40
OKU0041022	Ø22x19	1:1	4000	70Nm	-	X	-	78.5	58.5	22	19	CHUB41	CH_VTCROCE_M10
OKU0041027	Ø27x21	1:1	4000	70Nm	-	X	-	78.5	58.5	27	21	CHUB41	CH_VTCROCE_M12

OKUMA
MOD: LB25/400 - LR25 - LU25M - LU400M
MODULO MOTORIZZATO RADIALE VDI40 H=75mm
Radial driven tool VDI40 H=75mm
Radial angetriebenes Werkzeug VDI40 H=75mm

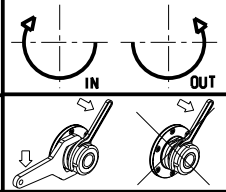

M.T. srl
Via Casino Albini 480
Tel. 0541/956034-957884
Fax 0541/956341
47842 S. GIOVANNI IN M. (RN)
e-mail: mtma@mtmarchetti.com
<http://www.mtmarchetti.com>

PRODUZIONE MODULI ROTANTI

PAGINA OKU013-3-10

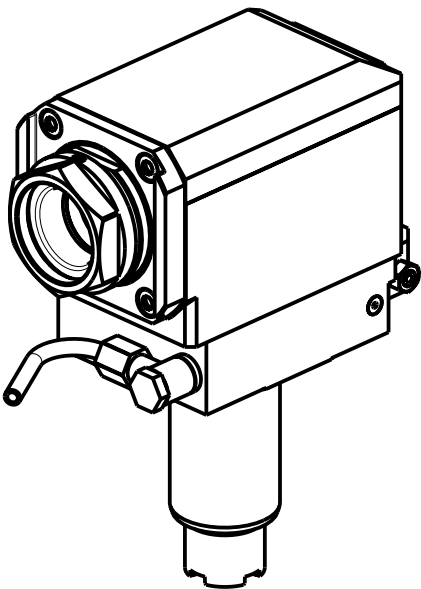
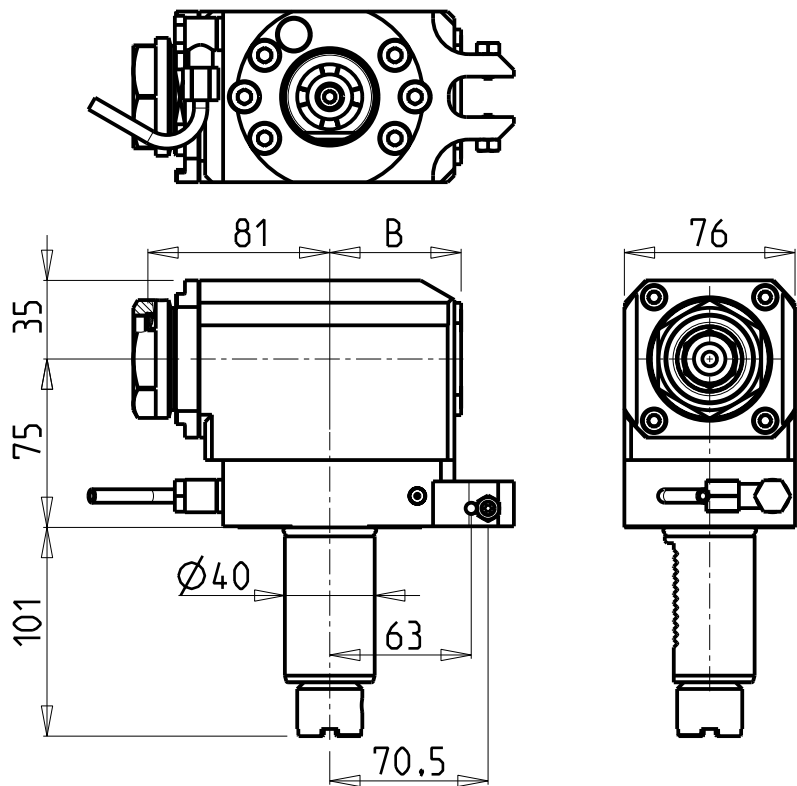

ATTENZIONE - ATTENTION - ACHTUNG

- Per lo smontaggio degli utensili utilizzare sempre la chiave di contrasto come indicato nel manuale d'uso.
- For disassembly of the tools use always the contrast key as mentioned in the user instructions.
- Fuer das Abmontieren der Werkzeuge immer den Gegenschlüssel benutzen wie in der Bedienungsanleitung erwaeht.

**TORRETTE ASSIALI
AXIAL TURRETS
AXIAL REVOLVER**

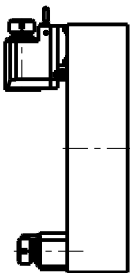

PER PORTAUTENSILI MODULARI MTSK-40 VEDI PAG. TBL300-1-40
FOR MTSK-40 QUIK CHANGE TOOLHOLDERS CLAMPINGS SEE PAGE TBL300-1-40
FUER MTSK-40 MODULARE WERKZEUGAUFNAHMEN SIEHE SEITE TBL300-1-40

Cod. MT	Mandrino Spindle Spindel	I	RPM	Coppia Max Max Torque Max Drehmoment	Lubrificazione int. Coolant through Innenkuehlung	Lubrificazione est. Ext. coolant Aussenkuehlung	B	CHIAVI NON INCLUSE Keys not included Schlüssel nicht einbegriffen	
OKU0841140	MTSK-40	1:1	4000	70Nm	-	X	58.5	CHUB46	OKU0650004 ■
OKU0841240	MTSK-40	1:1	4000	70Nm	P=70bar	X	69.5	CHUB46	OKU0650004 ■

- Chiave inclusa
- Key included
- Schlüssel inbegriffen

OKUMA
MOD: LB25/400 - LR25 - LU25M - LU400M
MODULO MOTORIZZATO RADIALE MTSK VD140 H=75mm
Radial MTSK driven tool VD140 H=75mm
Radial MTSK angetriebenes Werkzeug VD140 H=75mm

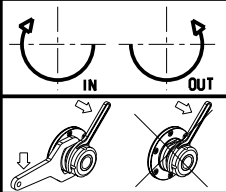

M.T. srl
Via Casino Albini 480
Tel. 0541/956034-957884
Fax 0541/956341
47842 S. GIOVANNI IN M. (RN)
e-mail: mtma@mtmarchetti.com
<http://www.mtmarchetti.com>

PRODUZIONE MODULI ROTANTI

PAGINA OKU013-3-10-K

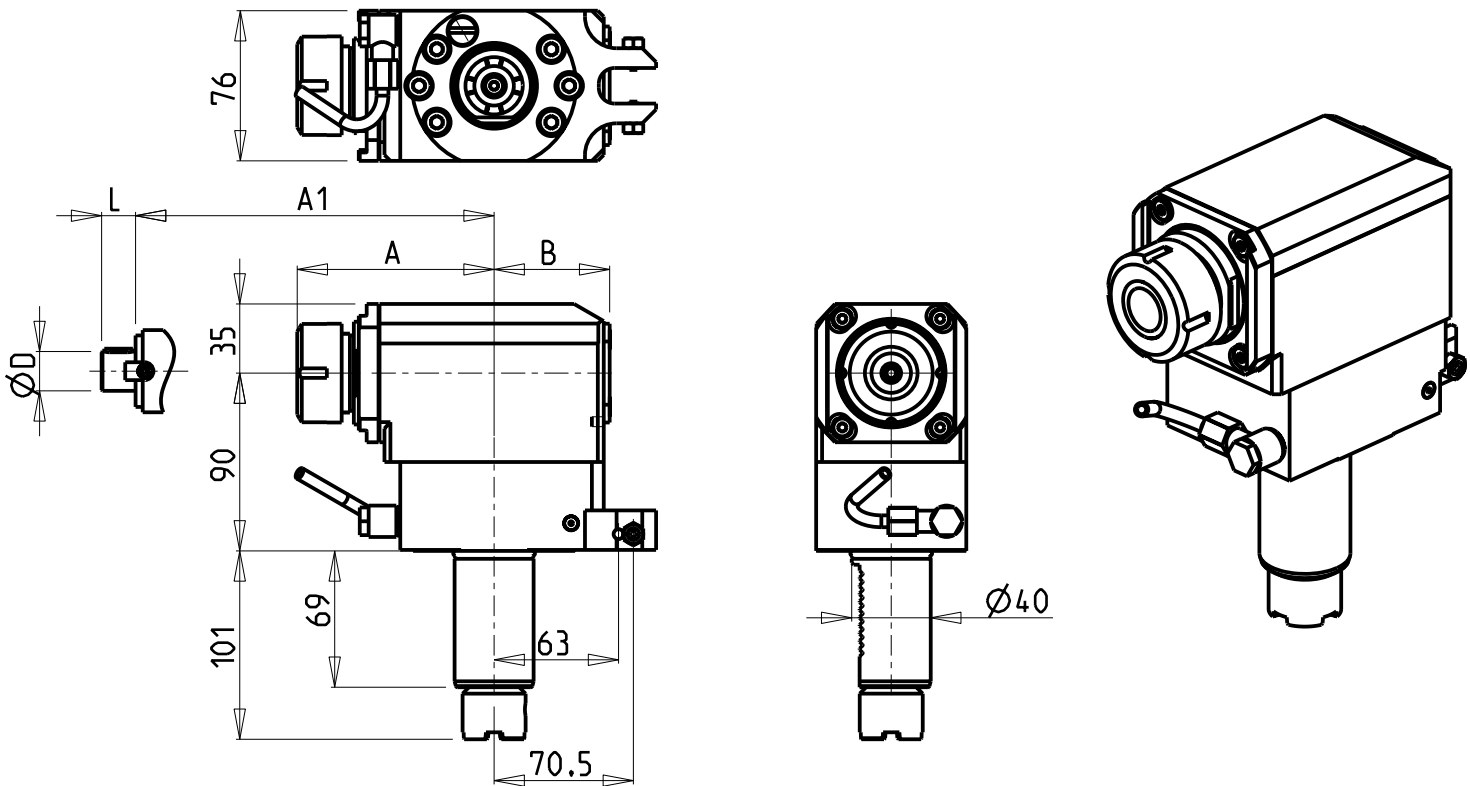

ATTENZIONE - ATTENTION - ACHTUNG

- Per lo smontaggio degli utensili utilizzare sempre la chiave di contrasto come indicato nel manuale d'uso.
- For disassembly of the tools use always the contrast key as mentioned in the user instructions.
- Fuer das Abmontieren der Werkzeuge immer den Gegenschlüssel benutzen wie in der Bedienungsanleitung erwaeht.

**TORRETTE ASSIALI
AXIAL TURRETS
AXIAL REVOLVER**

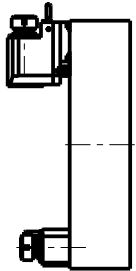

- Chiave inclusa
- Key included
- Schluessel inbegriffen

Cod. MT	Mandrino Spindle Spindel	I	RPM	Coppia Max Max Torque Max Drehmoment	Lubrificazione int. Coolant through Innenkuhlung	Lubrificazione est. Ext. coolant Aussenkuhlung	A	A1	B	D	L	CHIAVI NON INCLUDE Keys not included Schluessel nicht einbegriffen	
OKU0050332	ER32	1:1	4000	70Nm	-	X	99.7	-	58.5	-	-	OKU0650004	CHSTER32
OKU0050432	ER32	1:1	4000	70Nm	P=70bar	X	99.7	-	69.5	-	-	OKU0650004	CHSTER32
OKU0050340	ER40	1:1	4000	70Nm	-	X	103.7	-	58.5	-	-	OKU0650004	CHSTER40
OKU0050440	ER40	1:1	4000	70Nm	P=70bar	X	103.7	-	69.5	-	-	OKU0650004	CHSTER40
OKU0051022	Ø22x19	1:1	4000	70Nm	-	X	-	78.5	58.5	22	19	CHUB41	CH_VTCROCE_M10
OKU0051027	Ø27x21	1:1	4000	70Nm	-	X	-	78.5	58.5	27	21	CHUB41	CH_VTCROCE_M12

OKUMA
MOD: LB25/400 - LR25 - LU25M - LU400M
MODULO MOTORIZZATO RADIALE VDI40 H=90mm
Radial driven tool VDI40 H=90mm
Radial angetriebenes Werkzeug VDI40 H=90mm

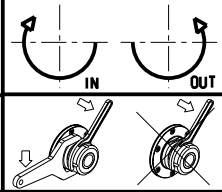

M.T. srl
Via Casino Albini 480
Tel. 0541/956034-957884
Fax 0541/956341
47842 S. GIOVANNI IN M. (RN)
e-mail: mtma@mtmarchetti.com
<http://www.mtmarchetti.com>

PRODUZIONE MODULI ROTANTI

PAGINA OKU013-3-20

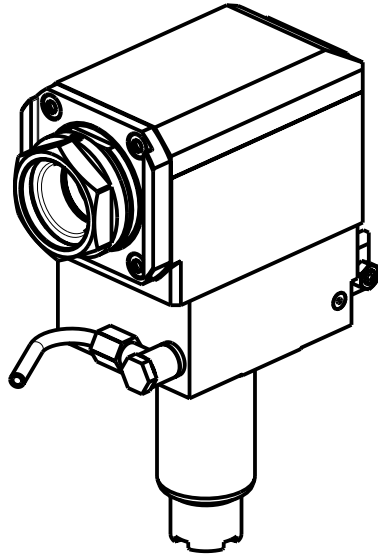
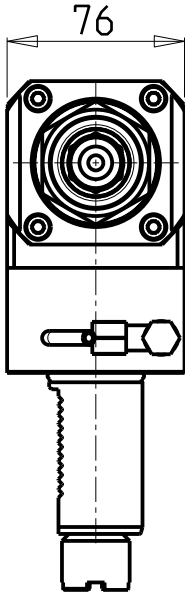
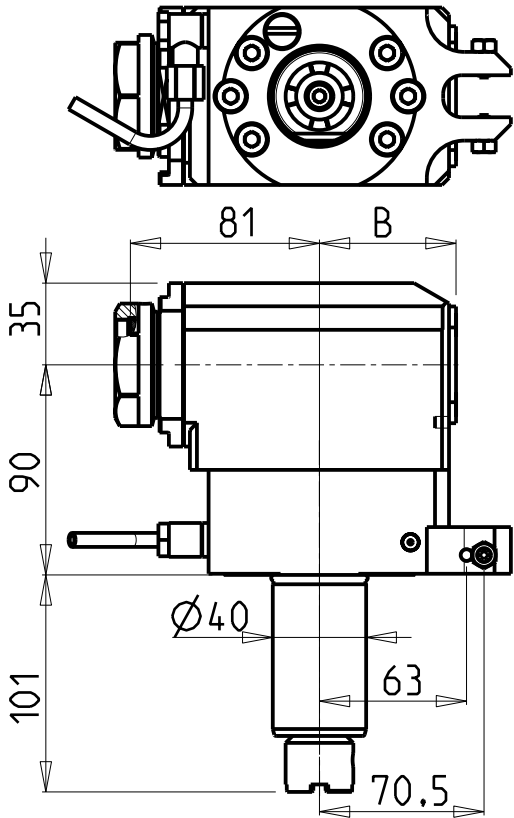

ATTENZIONE - ATTENTION - ACHTUNG

- Per lo smontaggio degli utensili utilizzare sempre la chiave di contrasto come indicato nel manuale d'uso.
- For disassembly of the tools use always the contrast key as mentioned in the user instructions.
- Fuer das Abmontieren der Werkzeuge immer den Gegenschlüssel benutzen wie in der Bedienungsanleitung erwaeht.

**TORRETTE ASSIALI
AXIAL TURRETS
AXIAL REVOLVER**

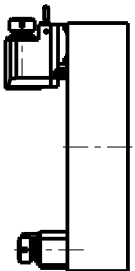

PER PORTAUTENSILI MODULARI MTSK-40 VEDI PAG. TBL300-1-40
FOR MTSK-40 QUIK CHANGE TOOLHOLDERS CLAMPINGS SEE PAGE TBL300-1-40
FUER MTSK-40 MODULARE WERKZEUGAUFNAHMEN SIEHE SEITE TBL300-1-40

Cod. MT	Mandrino Spindle Spindel	I	RPM	Coppia Max Max Torque Max Drehmoment	Lubrificazione int. Coolant through Innenkuehlung	Lubrificazione est. Ext. coolant Aussenkuehlung	B	CHIAVI NON INCLUDE Keys not included Schluessel nicht einbegriffen	
OKU0851140	MTSK-40	1:1	4000	70Nm	-	X	58.5	CHUB46	OKU0650004 *
OKU0851240	MTSK-40	1:1	4000	70Nm	P=70bar	X	69.5	CHUB46	OKU0650004 *

• Chiave inclusa
• Key included
• Schluessel inbegriffen

OKUMA
MOD: LB25/400 - LR25 - LU25M - LU400M
MODULO MOTORIZZATO RADIALE MTSK VD140 H=90mm
Radial MTSK driven tool VD140 H=90mm
Radial MTSK angetriebenes Werkzeug VD140 H=90mm

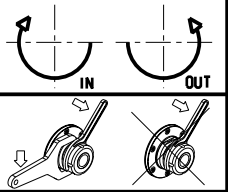

M.T. srl
Via Casino Albini 480
Tel. 0541/956034-957884
Fax 0541/956341
47842 S. GIOVANNI IN M. (RN)
e-mail: mtma@mtmarchetti.com
<http://www.mtmarchetti.com>

PRODUZIONE MODULI ROTANTI

PAGINA OKU013-3-20-K

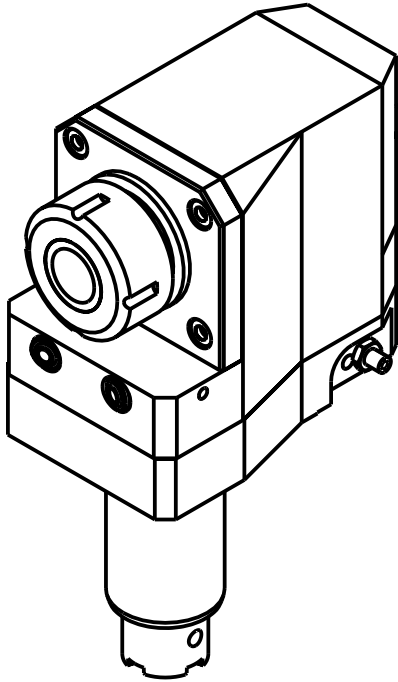
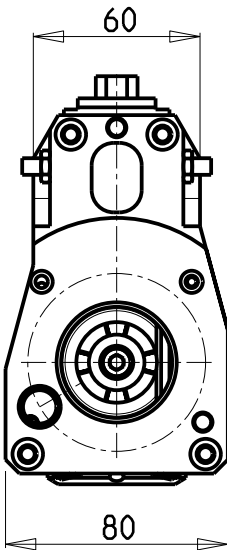
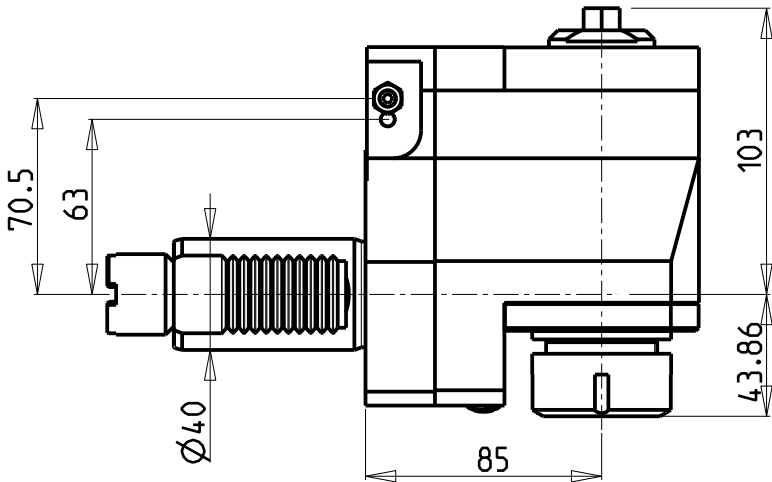
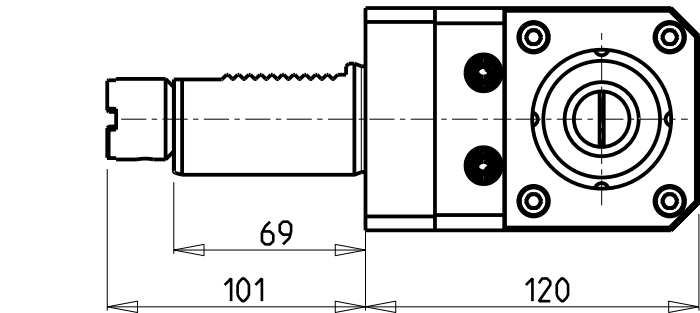

ATTENZIONE - ATTENTION - ACHTUNG

- Per lo smontaggio degli utensili utilizzare sempre la chiave di contrasto come indicato nel manuale d'uso.
- For disassembly of the tools use always the contrast key as mentioned in the user instructions.
- Fuer das Abmontieren der Werkzeuge immer den Gegenschlüssel benutzen wie in der Bedienungsanleitung erwaeht.

**TORRETTE ASSIALI
AXIAL TURRETS
AXIAL REVOLVER**

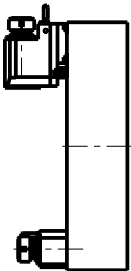

Cod. MT	Mandrino Spindle Spindel	I	RPM	Coppia Max Max Torque Max Drehmoment	Lubrificazione est. Ext. coolant Aussenkuehlung	CHIAVI NON INCLUSE Keys not included Schlüssel nicht einbegriffen	
1210KU_R32_40B01	ER32	1:1	4000	70Nm	X	CHUB13	CHSTER32

OKUMA
MOD: LB25/400 - LR25 - LU25M - LU400M
MODULO MOTORIZZATO RADIALE ARRETRATO VD140
Radial rear-set driven tool VD140
Radial angetriebenes Werkzeug zurueckversetzt VD140

Subject to change without notice.

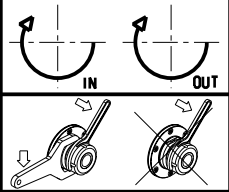

M.T. srl
Via Casino Albini 480
Tel. 0541/956034-957884
Fax 0541/956341
47842 S. GIOVANNI IN M. (RN)
e-mail: mtma@mtmarchetti.com
<http://www.mtmarchetti.com>

PRODUZIONE MODULI ROTANTI

PAGINA OKU015-3-00

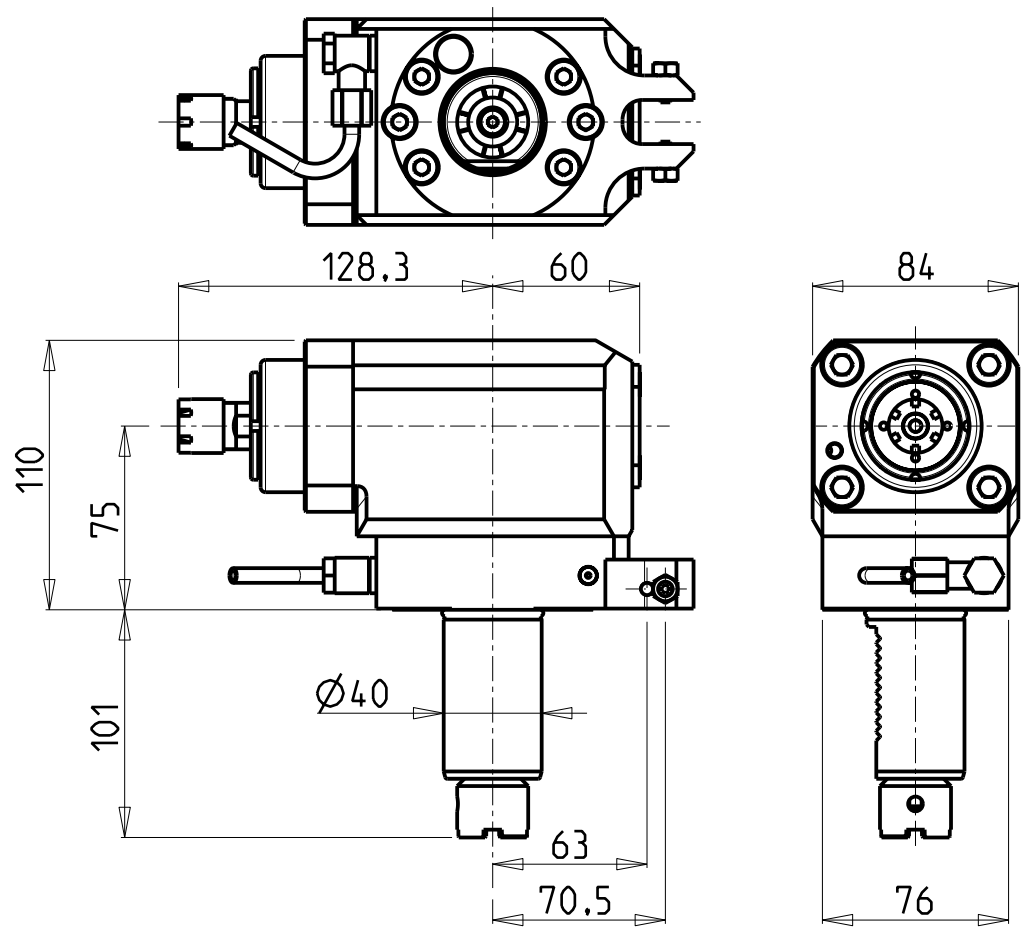

ATTENZIONE - ATTENTION - ACHTUNG

- Per lo smontaggio degli utensili utilizzare sempre la chiave di contrasto come indicato nel manuale d'uso.
- For disassembly of the tools use always the contrast key as mentioned in the user instructions.
- Fuer das Abmontieren der Werkzeuge immer den Gegenschlüssel benutzen wie in der Bedienungsanleitung erwaeht.

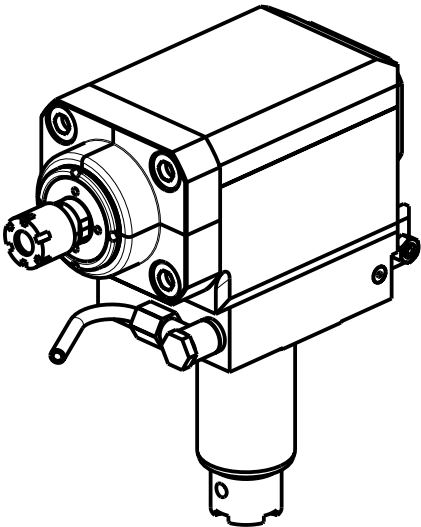

**TORRETTE ASSIALI
AXIAL TURRETS
AXIAL REVOLVER**

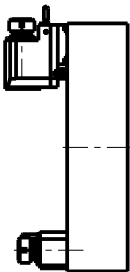

Cod. MT	Mandrino Spindle Spindel	I	RPM	Coppia Max Max Torque Max Drehmoment	Lubrificazione est. Ext. coolant Aussenkuehlung	CHIAVI INCLUSE Keys included Schluesssel einbegriffen	
OKU1291016	ER16	1:3	12000	10Nm	X	CHUB17	CHMNER16

OKUMA
MOD: LB25/400 - LR25 - LU25M - LU400M
MODULO MOTORIZZATO RADIALE MOLTIPLICATO I=1:3 VDI40 H=75mm
Radial geared-up I=1:3 driven tool VDI40 H=75mm
Radial angetriebenes Werkzeug uebersetzt I=1:3 VDI40 H=75mm

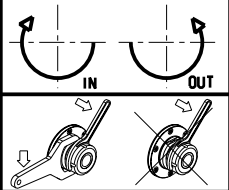

M.T. srl
Via Casino Albini 480
Tel. 0541/956034-957884
Fax 0541/956341
47842 S. GIOVANNI IN M. (RN)
e-mail: mtma@mtmarchetti.com
<http://www.mtmarchetti.com>

PRODUZIONE MODULI ROTANTI



PAGINA OKU018-3-14

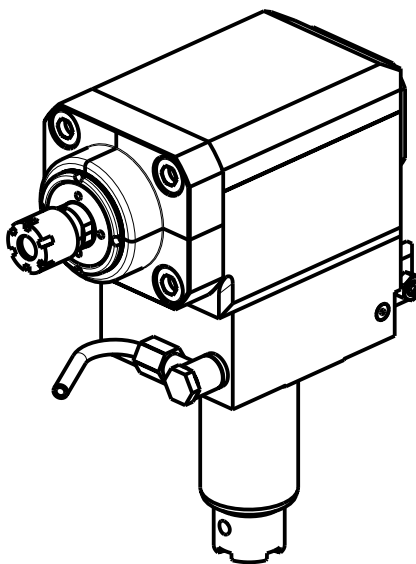
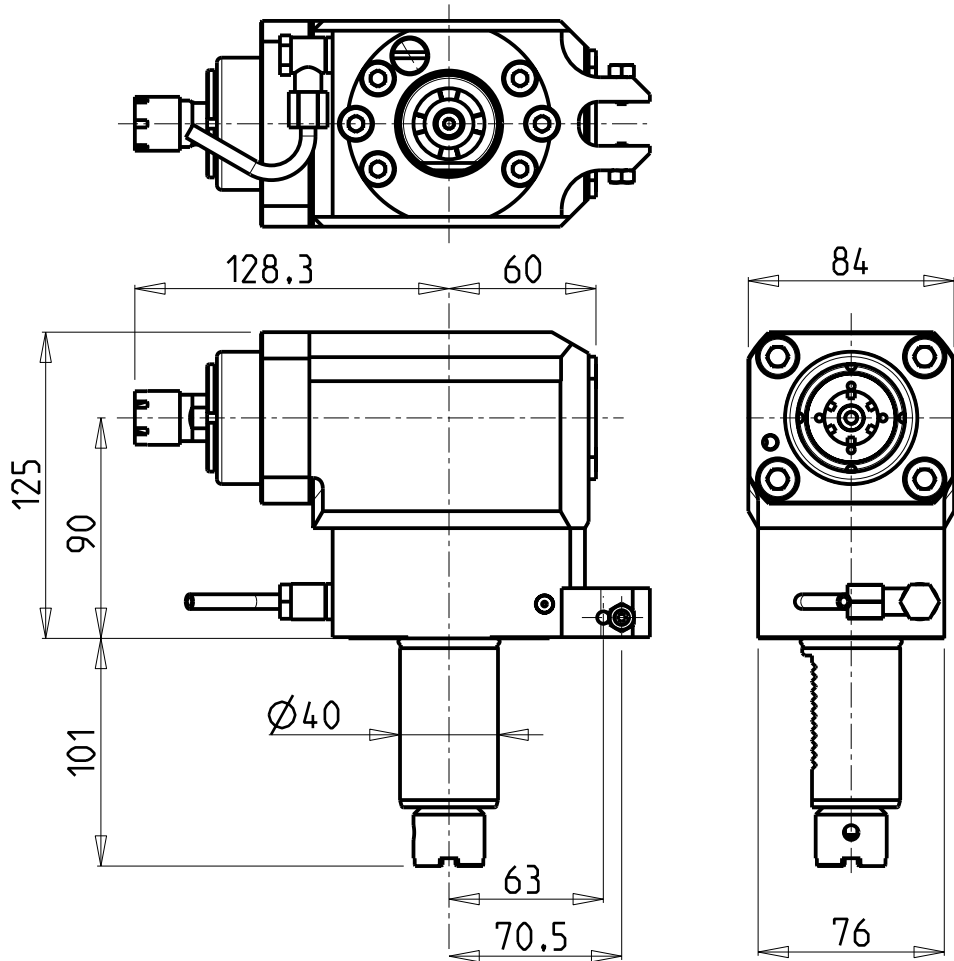

ATTENZIONE - ATTENTION - ACHTUNG

- Per lo smontaggio degli utensili utilizzare sempre la chiave di contrasto come indicato nel manuale d'uso.
- For disassembly of the tools use always the contrast key as mentioned in the user instructions.
- Fuer das Abmontieren der Werkzeuge immer den Gegenschlüssel benutzen wie in der Bedienungsanleitung erwaeht.

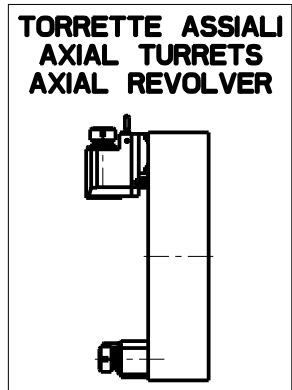

Cod. MT	Mandrino Spindle Spindel	I	RPM	Coppia Max Max Torque Max Drehmoment	Lubrificazione est. Ext. coolant Aussenkuehlung	CHIAVI INCLUSE Keys included Schluessel einbegriffen	
OKU1301016	ER16	1:3	12000	10Nm	X	CHUB17	CHMNER16

OKUMA
MOD: LB25/400 - LR25 - LU25M - LU400M
MODULO MOTORIZZATO RADIALE MOLTIPLICATO I=1:3 VDI40 H=90mm
Radial geared-up I=1:3 driven tool VDI40 H=90mm
Radial angetriebenes Werkzeug uebersetzt I=1:3 VDI40 H=90mm

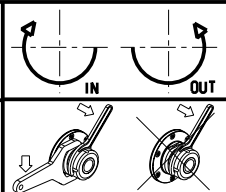

M.T. srl
Via Casino Albini 480
Tel. 0541/956034-957884
Fax 0541/956341
47842 S. GIOVANNI IN M. (RN)
e-mail: mtma@mtmarchetti.com
<http://www.mtmarchetti.com>

PRODUZIONE MODULI ROTANTI

PAGINA OKU018-3-24

PER LAVORAZIONI INTERNE
SU FORI Ø65 MINIMO

For machining internal
holes with Ø65 min. hole

Fuer interne Bearbeitungen
am loch minimum Ø65

ATTENZIONE - ATTENTION - ACHTUNG

- Per lo smontaggio degli utensili utilizzare sempre la chiave di contrasto come indicato nel manuale d'uso.
- For disassembly of the tools use always the contrast key as mentioned in the user instructions.
- Fuer das Abmontieren der Werkzeuge immer den Gegenschlüssel benutzen wie in der Bedienungsanleitung erwaeht.

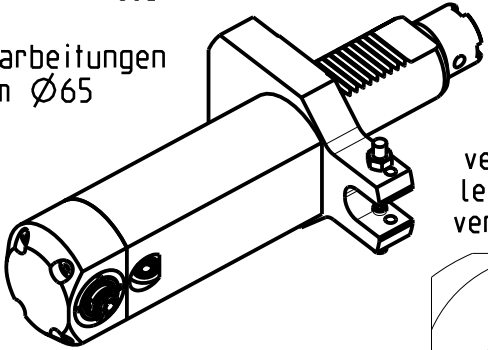
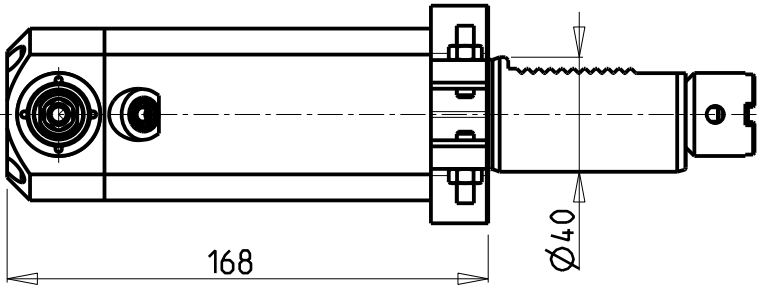

versione sx
left version
version links

versione dx
right version
version rechts

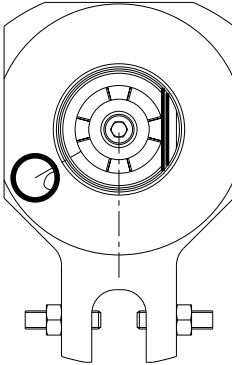
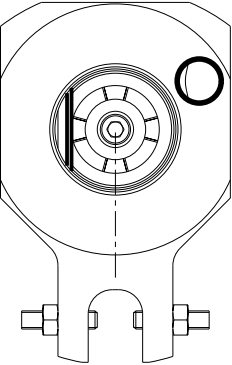
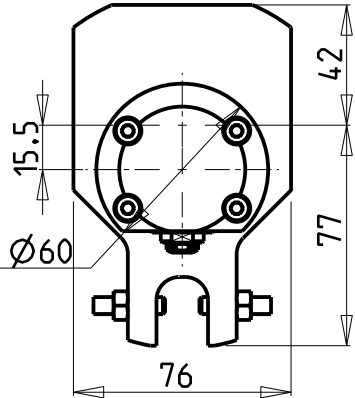
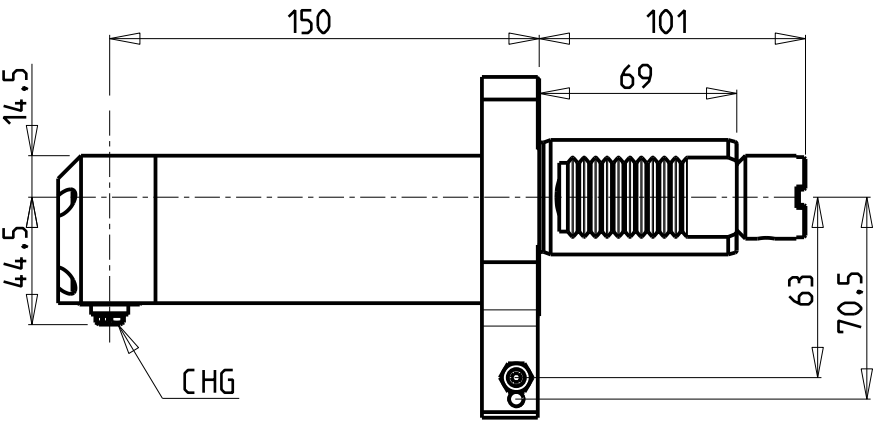

TORRETTE ASSIALI
AXIAL TURRETS
AXIAL REVOLVER

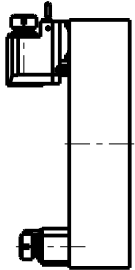

Cod. MT		Mandrino Spindle Spindel	I	RPM	Coppia Max Max Torque Max Drehmoment	Lubrificazione est. Ext. coolant Aussenkuehlung	CHIAVI INCLUSE Keys included Schlüssel einbegriffen	
versione sx left version version links	versione dx right version version rechts						CHUB13	CHCHG10
1270KU_R10_40B01	1270KU_R10_40B11	CHG	1:1	4000	10Nm	X		

OKUMA
MOD: LB25/400 - LR25 - LU25M - LU400M
MODULO MOTORIZZATO RADIALE VDI40 H=150mm
Radial driven tool VDI40 H=150mm
Radial angetriebenes Werkzeug VDI40 H=150mm

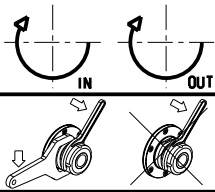

M.T. srl
Via Casino Albini 480
Tel. 0541/956034-957884
Fax 0541/956341
47842 S. GIOVANNI IN M. (RN)
e-mail: mtma@mtmarchetti.com
<http://www.mtmarchetti.com>

PRODUZIONE MODULI ROTANTI

PAGINA OKU125-3-00

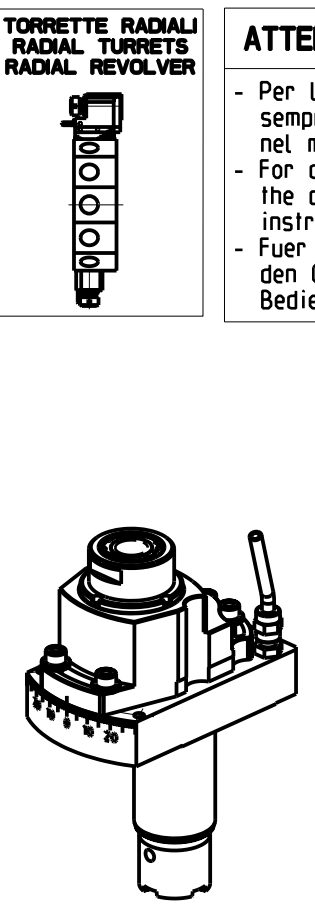
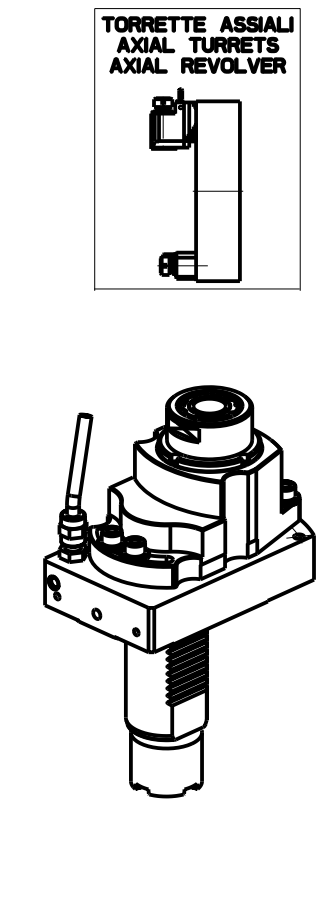
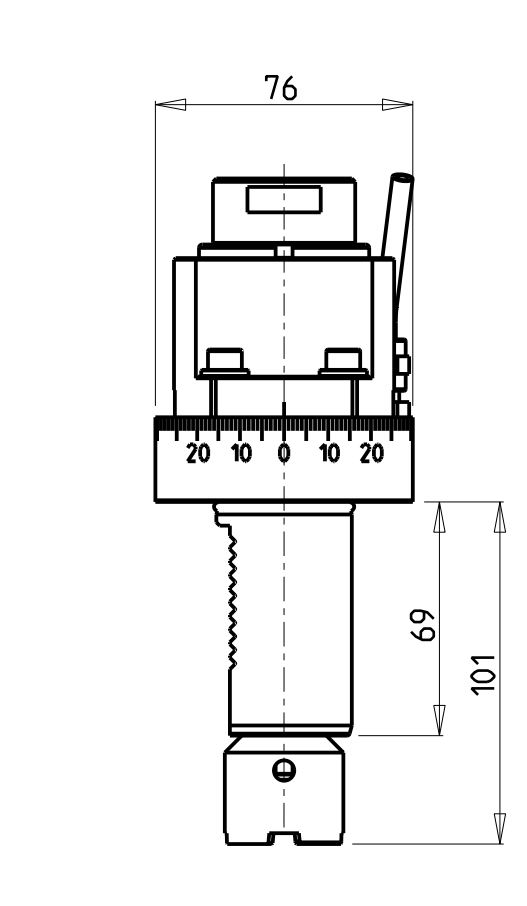
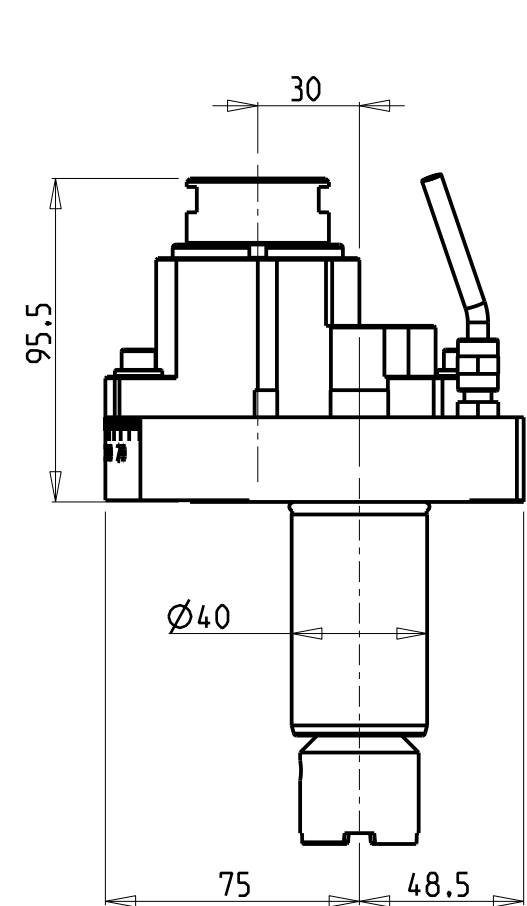

TORRETTE ASSIALI
AXIAL TURRETS
AXIAL REVOLVER

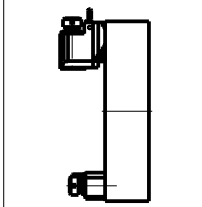

TORRETTE RADIALI
RADIAL TURRETS
RADIAL REVOLVER

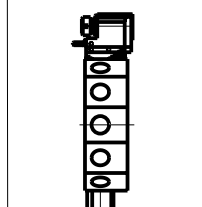

ATTENZIONE - ATTENTION - ACHTUNG

- Per lo smontaggio degli utensili utilizzare sempre la chiave di contrasto come indicato nel manuale d'uso.
- For disassembly of the tools use always the contrast key as mentioned in the user instructions.
- Fuer das Abmontieren der Werkzeuge immer den Gegenschlüssel benutzen wie in der Bedienungsanleitung erwaeht.

Cod. MT	Mandrino Spindle Spindel	I	RPM	Coppia Max Max Torque Max Drehmoment	Lubrificazione est. Ext. coolant Aussenkuehlung	CHIAVI NON INCLUSE Keys not included Schluessel nicht einbegriffen		
OKU1600325	ERA25	1:1	4000	40Nm	X	CHUB36	CHUB27	CHTAER25ZC •

- Chiave inclusa
- Key included
- Schluessel inbegriffen

OKUMA
MOD: LB25/400 - LR25 - LU25M - LU400M
MODULO MOTORIZZATO ASSIALE DISASSATO 30mm ORIENTABILE $\pm 30^\circ$ VD140
Axial $\pm 30^\circ$ adjustable angle driven tool re-directed by 30mm VD140
Axial angetriebenes Werkzeug schwenkbar $\pm 30^\circ$ achsversetzt um 30mm VD140
Subject to change without notice.

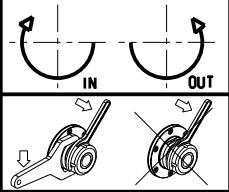

M.T. srl
Via Casino Albini 480
Tel. 0541/956034-957884
Fax 0541/956341
47842 S. GIOVANNI IN M. (RN)
e-mail: mtma@mtmarchetti.com
<http://www.mtmarchetti.com>

PRODUZIONE MODULI ROTANTI



PAGINA OKU135-3-00

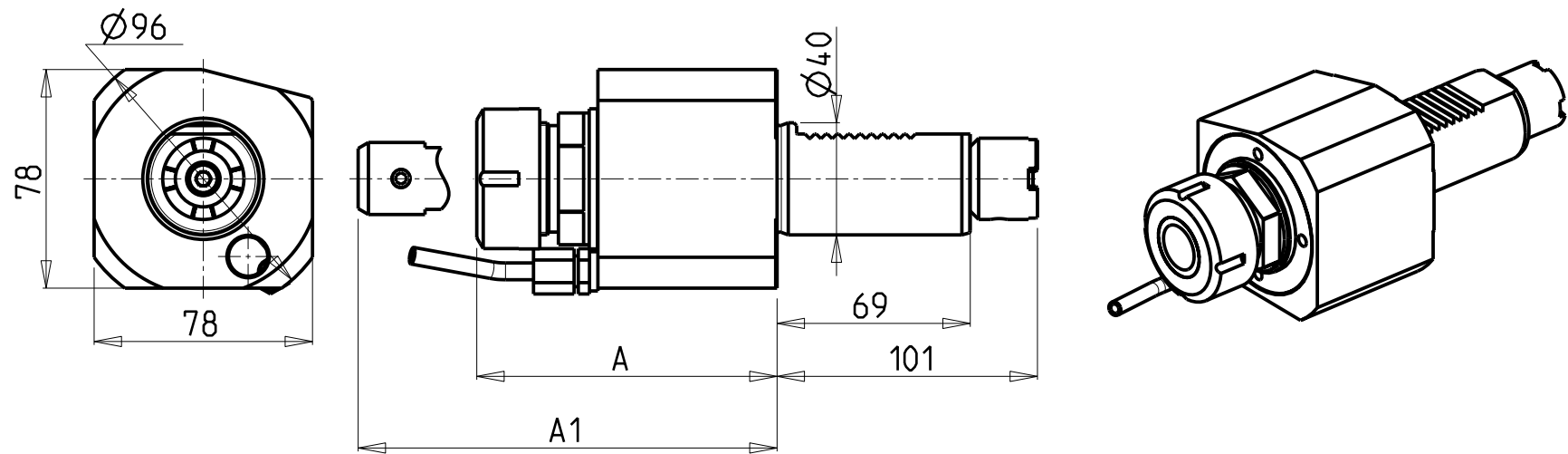

TORRETTE ASSIALI
AXIAL TURRETS
AXIAL REVOLVER

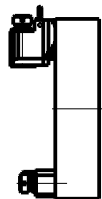

TORRETTE RADIALI
RADIAL TURRETS
RADIAL REVOLVER

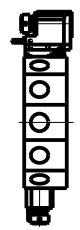

Cod. MT	Mandrino Spindle Spindel	I	RPM	Coppia Max Max Torque Max Drehmoment	Lubrificazione est. Ext. coolant Aussenkuehlung	Lubrificazione int. Coolant through Innenkuehlung	A	A1	CHIAVI NON INCLUSE Keys not included Schluessel nicht einbegriffen	
1220KU_A32_40B01	ER32	1:1	4000	70Nm	X	-	107.3	-	CHUB41	CHSTER32
OKU1211232	ER32	1:1	4000	70Nm	X	P=30bar	110.5	-	CHUB41	CHSTER32
OKU1211240	ER40	1:1	4000	70Nm	X	P=30bar	113.5	-	CHUB46	CHSTER40
1220KU_A32_40B11	WELDON 8	1:1	4000	70Nm	X	-	-	88.1	-	-
1220KU_A32_40B13	WELDON 12	1:1	4000	70Nm	X	-	-	92.6	-	-
1220KU_A32_40B15	WELDON 16	1:1	4000	70Nm	X	-	-	95.1	-	-

OKUMA
MOD: LB25/400 - LR25 - LU25M - LU400M
MODULO MOTORIZZATO ASSIALE VDI40
Axial driven tool VDI40
Axial angetriebenes Werkzeug VDI40

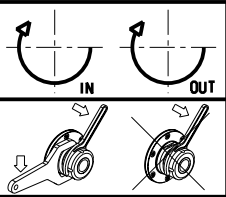

M.T. srl
Via Casino Albini 480
Tel. 0541/956034-957884
Fax 0541/956341
47842 S. GIOVANNI IN M. (RN)
e-mail: mtma@mtmarchetti.com
<http://www.mtmarchetti.com>

PRODUZIONE MODULI ROTANTI



PAGINA OKU150-3-00

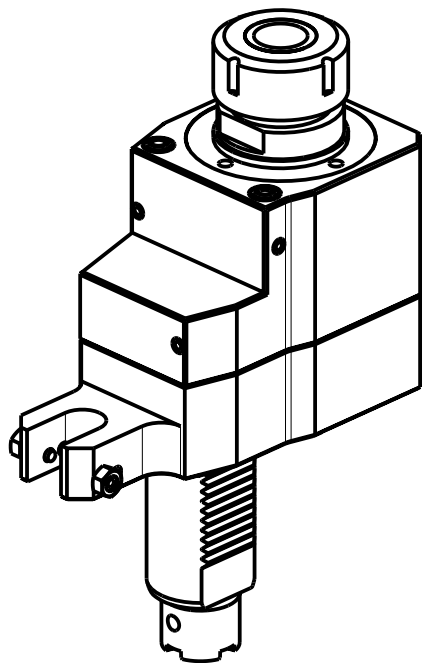
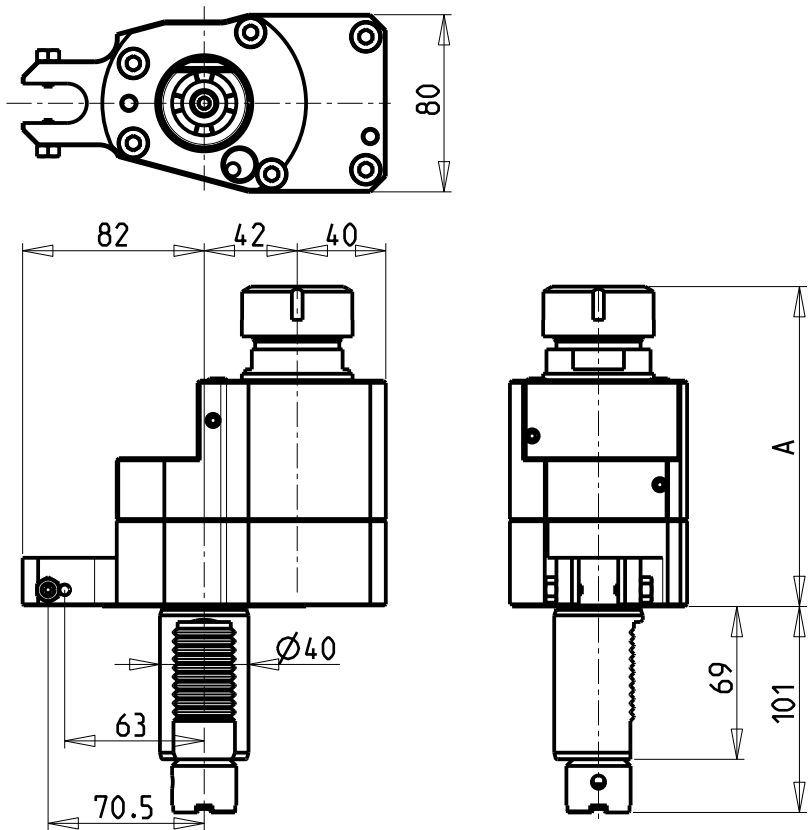

ATTENZIONE - ATTENTION - ACHTUNG

- Per lo smontaggio degli utensili utilizzare sempre la chiave di contrasto come indicato nel manuale d'uso.
- For disassembly of the tools use always the contrast key as mentioned in the user instructions.
- Fuer das Abmontieren der Werkzeuge immer den Gegenschlüssel benutzen wie in der Bedienungsanleitung erwaeht.

**TORRETTE ASSIALI
AXIAL TURRETS
AXIAL REVOLVER**

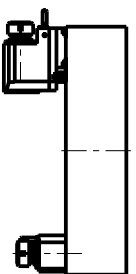

Cod. MT	Mandrino Spindle Spindel	I	RPM	Coppia Max Max Torque Max Drehmoment	Lubrificazione int. Coolant through Innenkuehlung	Lubrificazione est. Ext. coolant Aussenkuehlung	A	CHIAVI NON INCLUSE Keys not included Schluessel nicht einbegriffen	
1250KU_A32_40B01	ER32	1:1	4000	70Nm		X	144.46	CHUB41	CHSTER32
1250KU_A32_40B31	ER32	1:1	4000	70Nm	P=30bar		164.96	CHUB38	CHSTER32

OKUMA
MOD: LB25/400 - LR25 - LU25M - LU400M
MODULO MOTORIZZATO ASSIALE DISASSATO VD140
Axial re-directed driven tool VD140
Axial angetriebenes Werkzeug achsversetzt VD140

Subject to change without notice.

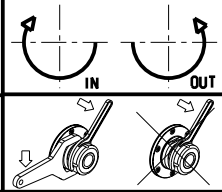

M.T. srl
Via Casino Albini 480
Tel. 0541/956034-957884
Fax 0541/956341
47842 S. GIOVANNI IN M. (RN)
e-mail: mtma@mtmarchetti.com
<http://www.mtmarchetti.com>

PRODUZIONE MODULI ROTANTI



PAGINA OKU160-3-00

ATTENZIONE - ATTENTION - ACHTUNG

- Per lo smontaggio degli utensili utilizzare sempre la chiave di contrasto come indicato nel manuale d'uso.
- For disassembly of the tools use always the contrast key as mentioned in the user instructions.
- Fuer das Abmontieren der Werkzeuge immer den Gegenschlüssel benutzen wie in der Bedienungsanleitung erwaeht.

TORRETTE ASSIALI
AXIAL TURRETS
AXIAL REVOLVER

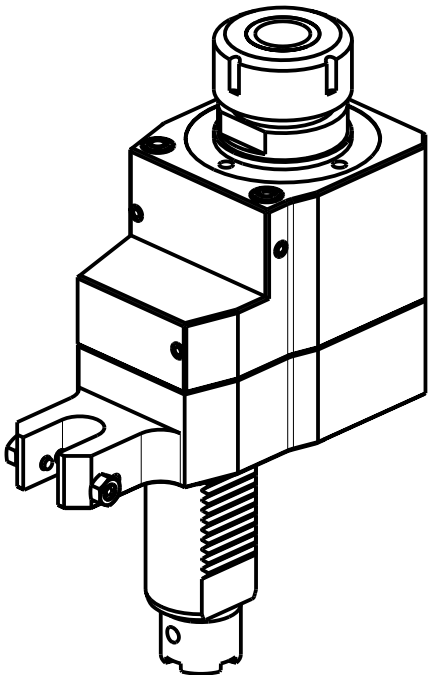
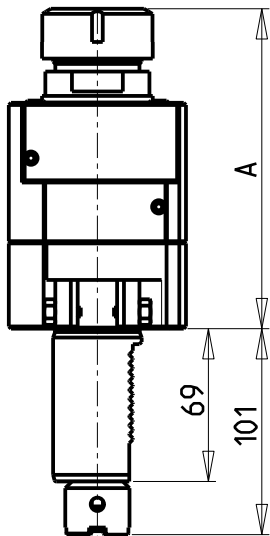
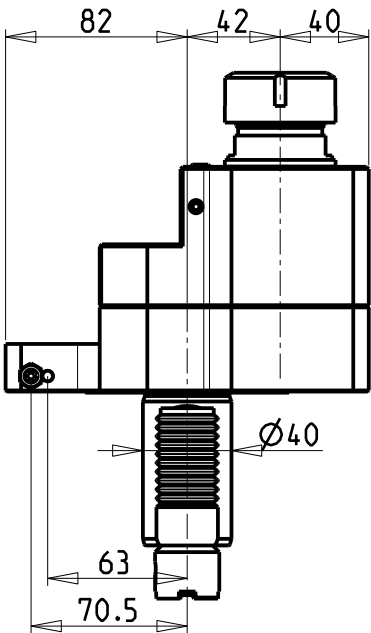
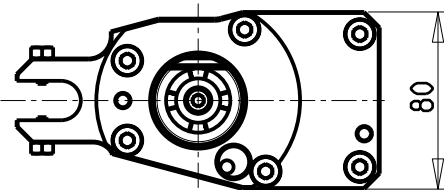
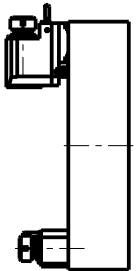

Cod. MT	Mandrino Spindle Spindel	I	RPM	Coppia Max Max Torque Max Drehmoment	Lubrificazione int. Coolant through Innenkuehlung	Lubrificazione est. Ext. coolant Aussenkuehlung	A	CHIAVI NON INCLUSE Keys not included Schlüssel nicht einbegriffen	
1250KU_A32_40B11	ER32	2:1	2000	100Nm		X	144.46	CHUB41	CHSTER32
1250KU_A32_40B21	ER32	2:1	2000	100Nm	P=30bar		164.96	CHUB38	CHSTER32

OKUMA
MOD: LB25/400 - LR25 - LU25M - LU400M
MODULO MOTORIZZATO ASSIALE RIDOTTO I=2:1 DISASSATO VDI40
Axial geared-down I=2:1 driven tool re-directed VDI40
Axial angetriebenes Werkzeug untersetzt I=2:1 achsversetzt VDI40

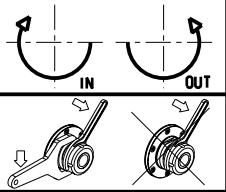

M.T. srl
Via Casino Albini 480
Tel. 0541/956034-957884
Fax 0541/956341
47842 S. GIOVANNI IN M. (RN)
e-mail: mtma@mtmarchetti.com
<http://www.mtmarchetti.com>

PRODUZIONE MODULI ROTANTI

PAGINA OKU160-3-10

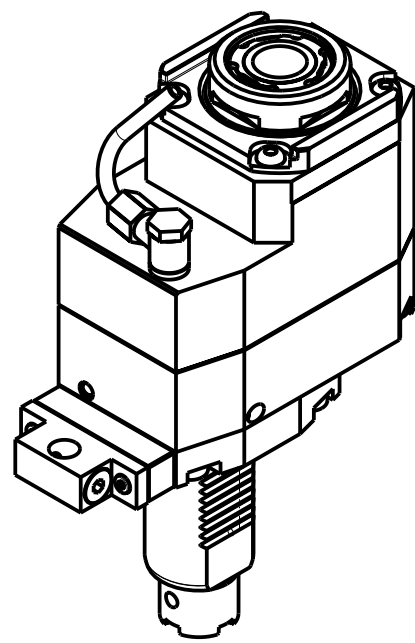
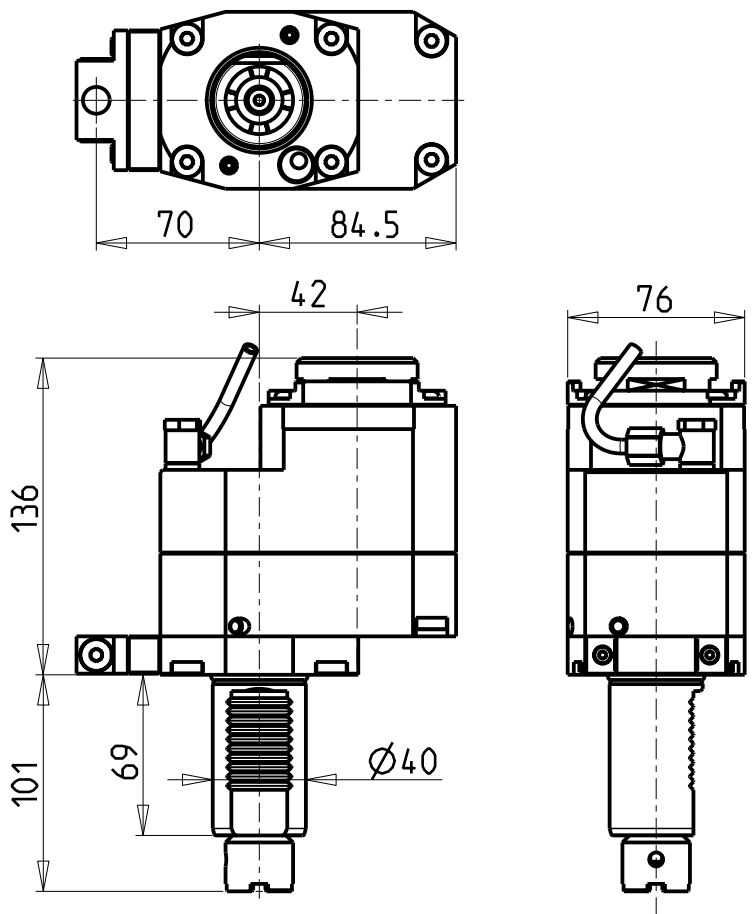

ATTENZIONE - ATTENTION - ACHTUNG

- Per lo smontaggio degli utensili utilizzare sempre la chiave di contrasto come indicato nel manuale d'uso.
- For disassembly of the tools use always the contrast key as mentioned in the user instructions.
- Fuer das Abmontieren der Werkzeuge immer den Gegenschluessel benutzen wie in der Bedienungsanleitung erwaeht.

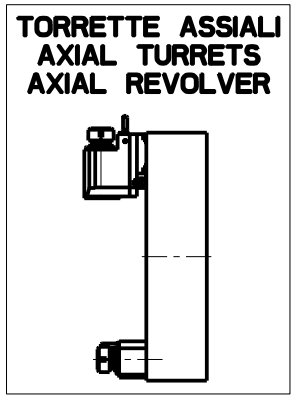

Cod. MT	Mandrino Spindle Spindel	I	RPM	Coppia Max Max Torque Max Drehmoment	Lubrificazione int. Coolant through Innenkuehlung	Lubrificazione est. Ext. coolant Aussenkuehlung	CHIAVI NON INCLUSE Keys not included Schluessel nicht einbegriffen		
OKU1207132	ERA32	1:2	8000	45Nm	-	X	CHUB30	CHTAER32ZC	OKU0650004
OKU1207232	ERA32	1:2	8000	45Nm	P=70bar	X	CHUB30	CHTAER32ZC	OKU0650004

- Chiave inclusa
- Key included
- Schluessel inbegriffen

OKUMA
MOD: LB25/400 - LR25 - LU25M - LU400M
MODULO MOTORIZZATO ASSIALE MOLTIPLICATO I=1:2 DISASSATO 42mm VD140
Axial geared-up I=1:2 driven tool re-directed by 42mm VD140
Axial angetriebenes Werkzeug uebersetzt I=1:2 achsversetzt um 42mm VD140
Subject to change without notice.

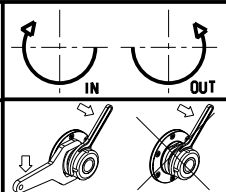

M.T. srl
Via Casino Albini 480
Tel. 0541/956034-957884
Fax 0541/956341
47842 S. GIOVANNI IN M. (RN)
e-mail: mtma@mtmarchetti.com
<http://www.mtmarchetti.com>

PRODUZIONE MODULI ROTANTI

PAGINA OKU160-3-20

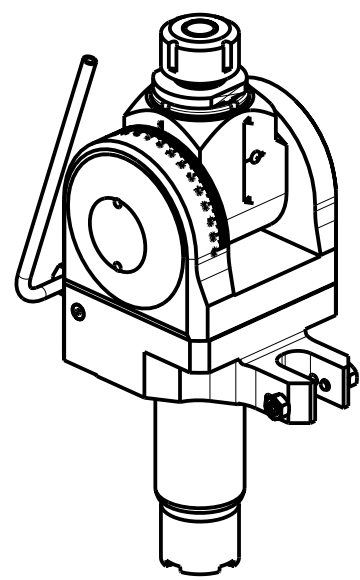
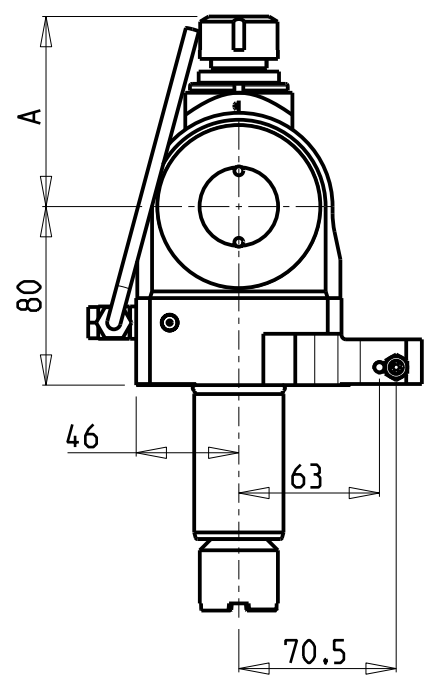
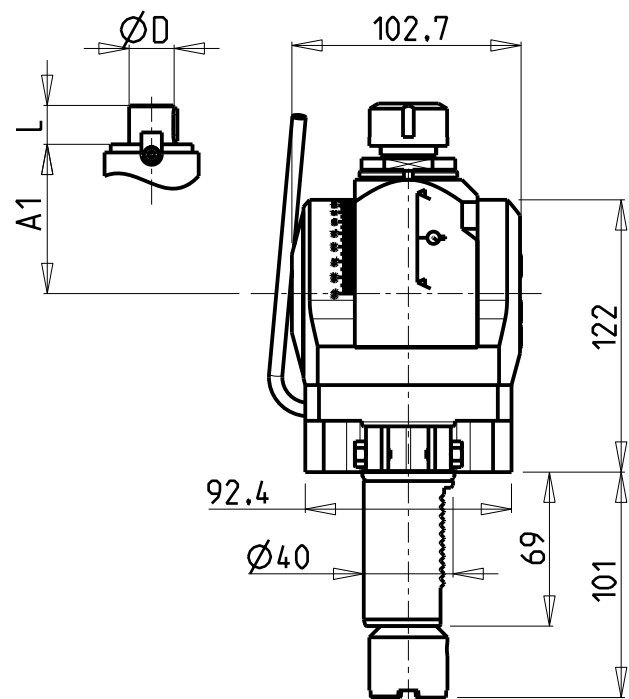

ATTENZIONE - ATTENTION - ACHTUNG

- Per lo smontaggio degli utensili utilizzare sempre la chiave di contrasto come indicato nel manuale d'uso.
- For disassembly of the tools use always the contrast key as mentioned in the user instructions.
- Fuer das Abmontieren der Werkzeuge immer den Gegenschlüssel benutzen wie in der Bedienungsanleitung erwaeht.

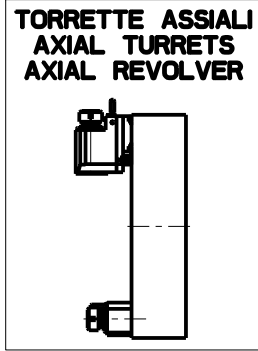

Cod. MT	Mandrino Spindle Spindel	I	RPM	Coppia Max Max Torque Max Drehmoment	Lubrificazione est. Ext. coolant Aussenkuehlung	A	A1	D	L	CHIAVI INCLUSE Keys included Schluessel inbegriffen	
OKU1500120	ER20	1:1	4000	40Nm	X	85.16	-	-	-	CHUB36	CHSTER20
OKU1500125	ER25	1:1	4000	40Nm	X	86.16	-	-	-	CHUB36	CHSTER25
OKU1500516	Ø16x17	1:1	4000	40Nm	X	-	65	16	17	CHUB36	CH_VTCROCE_M08
OKU1500522	Ø22x19	1:1	4000	40Nm	X	-	65	22	19	CHUB36	CH_VTCROCE_M10
OKU1500519	Ø3/4"x3/4"	1:1	4000	40Nm	X	-	65	3/4"	3/4"	CHUB36	CH_VTCROCE_M08

OKUMA
MOD: LB25/400 - LR25 - LU25M - LU400M
MODULO MOTORIZZATO ORIENTABILE ±90° VD140
±90° adjustable angle driven tool VD140
Angetriebenes Werkzeug schwenkbar ±90° VD140

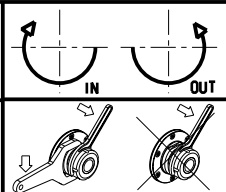

M.T. srl
Via Casino Albini 480
Tel. 0541/956034-957884
Fax 0541/956341
47842 S. GIOVANNI IN M. (RN)
e-mail: mtma@mtmarchetti.com
<http://www.mtmarchetti.com>

PRODUZIONE MODULI ROTANTI

PAGINA OKU333-3-00

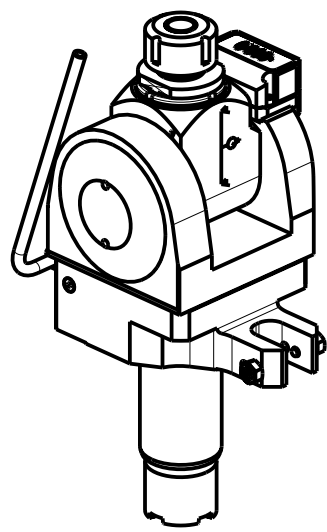
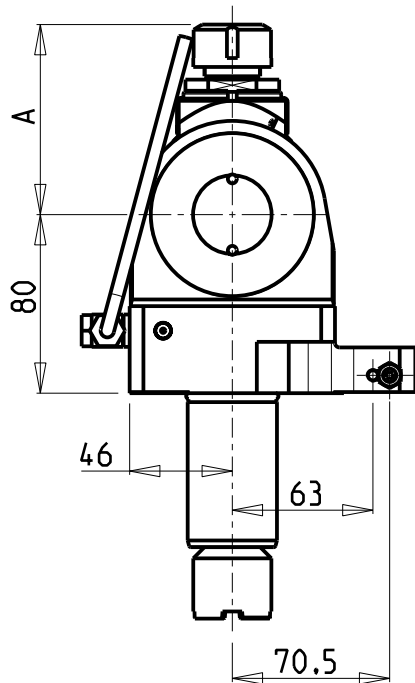
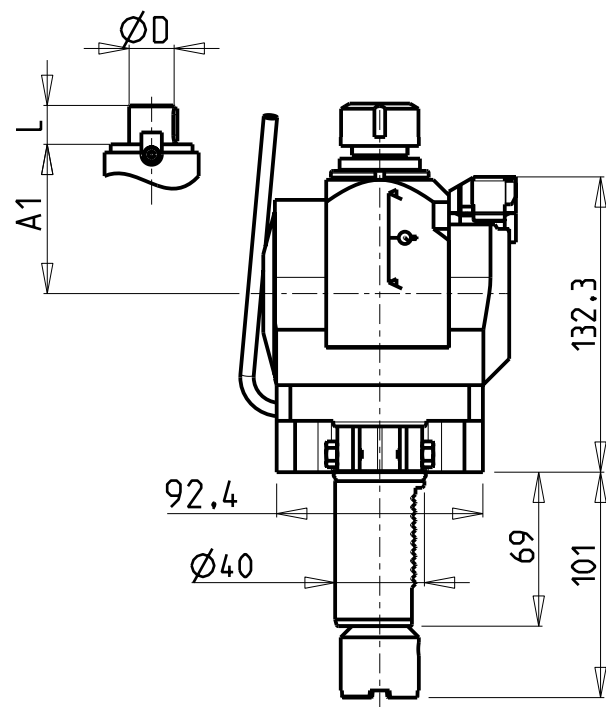

ATTENZIONE - ATTENTION - ACHTUNG

- Per lo smontaggio degli utensili utilizzare sempre la chiave di contrasto come indicato nel manuale d'uso.
- For disassembly of the tools use always the contrast key as mentioned in the user instructions.
- Fuer das Abmontieren der Werkzeuge immer den Gegenschlüssel benutzen wie in der Bedienungsanleitung erwaeht.

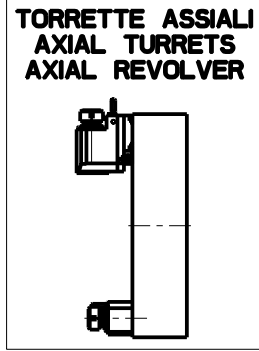

Cod. MT	Mandrino Spindle Spindel	I	RPM	Coppia Max Max Torque Max Drehmoment	Lubrificazione est. Ext. coolant Aussenkuehlung	A	A1	D	L	CHIAVI INCLUSE Keys included Schluessel inbegriffen	
OKU1440120	ER20	1:1	4000	40Nm	X	85.16	-	-	-	CHUB36	CHSTER20
OKU1440125	ER25	1:1	4000	40Nm	X	86.16	-	-	-	CHUB36	CHSTER25
OKU1440516	Ø16x17	1:1	4000	40Nm	X	-	65	16	17	CHUB36	CH_VTCROCE_M08
OKU1440522	Ø22x19	1:1	4000	40Nm	X	-	65	22	19	CHUB36	CH_VTCROCE_M10
OKU1440519	Ø3/4"x3/4"	1:1	4000	40Nm	X	-	65	3/4"	3/4"	CHUB36	CH_VTCROCE_M08

OKUMA
MOD: LB25/400 - LR25 - LU25M - LU400M
MODULO MOTORIZZATO ORIENTABILE ±90° CON NONIO DIGITALE VD140
±90° adjustable angle driven tool with digital display VD140
Angetriebenes Werkzeug schwenkbar ±90° mit digital display VD140

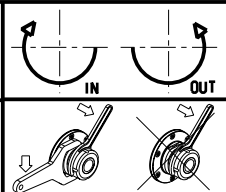

M.T. srl
Via Casino Albini 480
Tel. 0541/956034-957884
Fax 0541/956341
47842 S. GIOVANNI IN M. (RN)
e-mail: mtma@mtmarchetti.com
<http://www.mtmarchetti.com>

PRODUZIONE MODULI ROTANTI

PAGINA OKU333-3-01

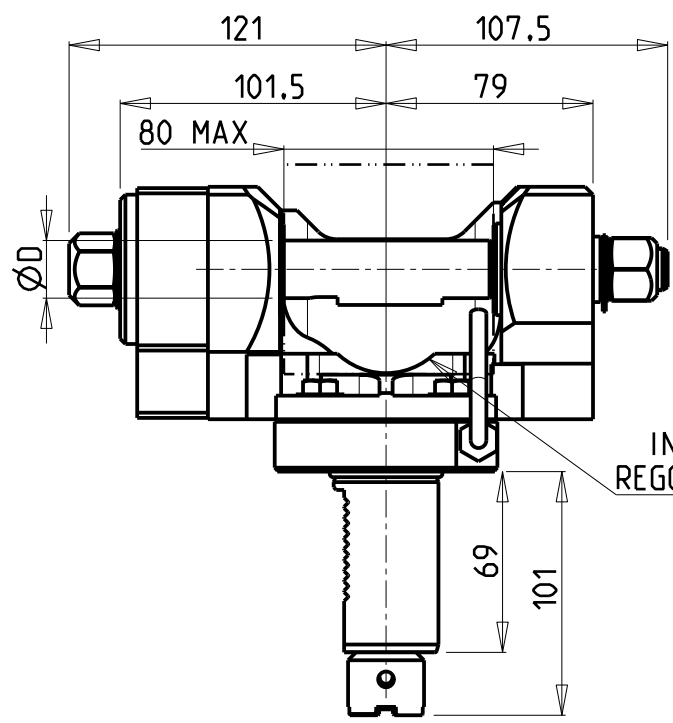
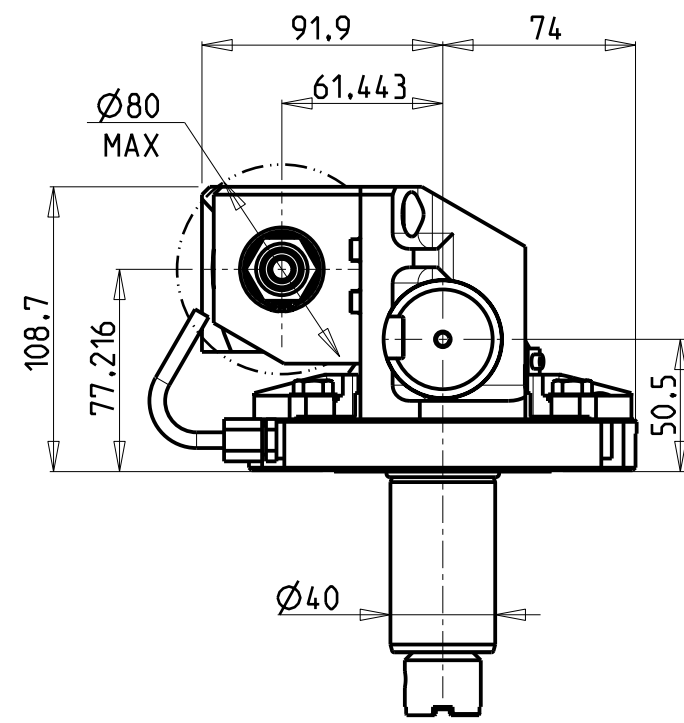

INCLINAZIONE
REGOLABILE ±20°

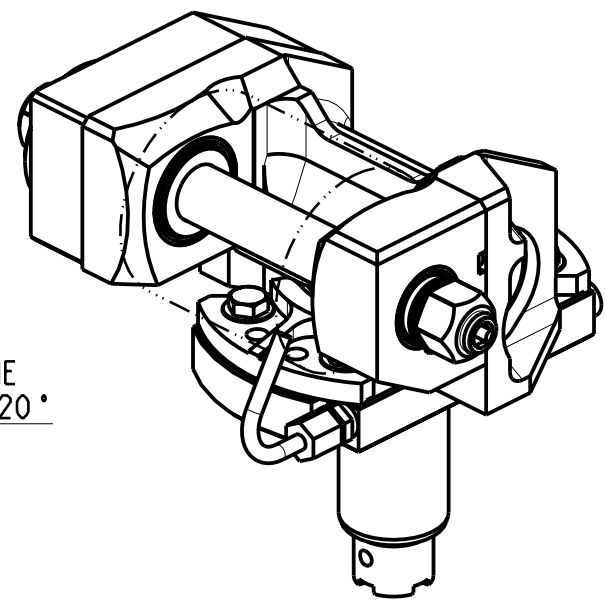

DOTAZIONI - SUPPLIED WITH - AUSSTATTUNG	
mm / inch	- N°1 ALBERO + DISTANZIALI - N°1 SHAFT + SPACER - N°1 DORN + ABSTANDSSTUECK

PER ALBERI E DISTANZIALI VEDI PAG. TBL250-1-00
FOR SHAFT END SPACER SEE PAGE TBL250-1-00
FUEER DORN UND ABSTANDSSTUECK SEITE TBL250-1-00

TORRETTE RADIALI
RADIAL TURRETS
RADIAL REVOLVER

Cod. MT	I	RPM MAX	Coppia Max Max Torque Max Drehmoment	Lubr.esterna Ext. coolant Aussenkuehlung	D (mm)	D (Inch)	CHIAVI INCLUSE Keys included Schlüssel inbegriffen		
1260KU_PCR_40B01	1:1	4000	60Nm	X	16-22-27-32	3/4"-1"-1 1/4"	CHUB13	CHUB24	CHESL08
1260KU_PCR_40B11	2:1	2000	80Nm	X	16-22-27-32	3/4"-1"-1 1/4"	CHUB13	CHUB24	CHESL08

OKUMA
MOD: LB25/400 - LR25 - LU25M - LU400M
MODULO MOTORIZZATO PORTACREATORE VDI40
Driven gear hobber VDI40
Angetriebenes Zahnradwaelzfraes-Werkzeug VDI40
Subject to change without notice.

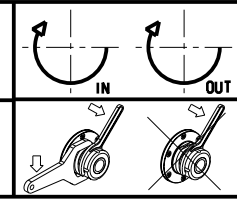

M.T. srl
Via Casino Albini 480
Tel. 0541/956034-957884
Fax 0541/956341
47842 S. GIOVANNI IN M. (RN)
e-mail: mtma@mtmarchetti.com
<http://www.mtmarchetti.com>

PRODUZIONE MODULI ROTANTI

PAGINA OKU340-3-00